

# THE BEAST

---



THE BEAST

# OVERVIEW.

**THE BEAST is robust, rugged and ready for adventures across the South Pacific. Scuba diving for 12 guests? Check. A 13m (42.7ft), 19-tonne fully kitted-out custom sports tender known as BABY BEAST? Check. Freezer rooms and live bait tanks for the serious big game fisher? Check. Shallow 2.5m (8.2ft) draft to get into places other yachts can't? Check.**

Inspired by military vessels but unashamedly luxurious inside and out, THE BEAST was built for an extremely experienced owner and delivered in 2019 by New Zealand shipyard Profab Engineering. Her refined muscularity was immediately recognised when she won a World Superyacht Award in 2020 for yachts under 499GT.

After getting up close and personal with the natural world, her 12 guests can toast their catch at the sun deck's sit-up bar then enjoy it freshly grilled Teppanyaki-style before gathering at the observation lounge forward or stretching out on the sun loungers aft. There's more open air dining on the bridge deck aft as well as lounge areas fore and aft for your digestif and another intimate shaded lounge on the main deck aft where you can watch the miles unwind.

Inside she has cool, contemporary relaxed interiors with generous natural light in all guest areas to make the most of the spectacular views. The bridge deck has a media lounge where you can watch footage of the day's action and there is formal dining and a lounge on the main deck.

This is not just a luxurious charter yacht with a crew of nine. This is a yacht with a thirst for thrills, an appetite for action and a crew that can't wait to deliver both. If that sounds like something you need in your life, get in touch.

## Key features

---

**Winner of best Displacement Motor Yachts Below 499GT - 30m to 39.9m at The World Superyacht Awards 2020**

---

**Three VIP cabins on the main deck**

---

**Exercise equipment**

---

**A pedal powered catamaran - Schiller Bike**

---

**Dedicated fishing tender**

---

**A good choice of exterior and interior dining areas**

---

**Advanced stabilisation technology used in the hull design**

---

# THE BEAST

At anchor



Sun deck with Teppanyaki set-up



Teppanyaki grill



Bridge deck dining area



## THE BEAST

Bridge deck dining area

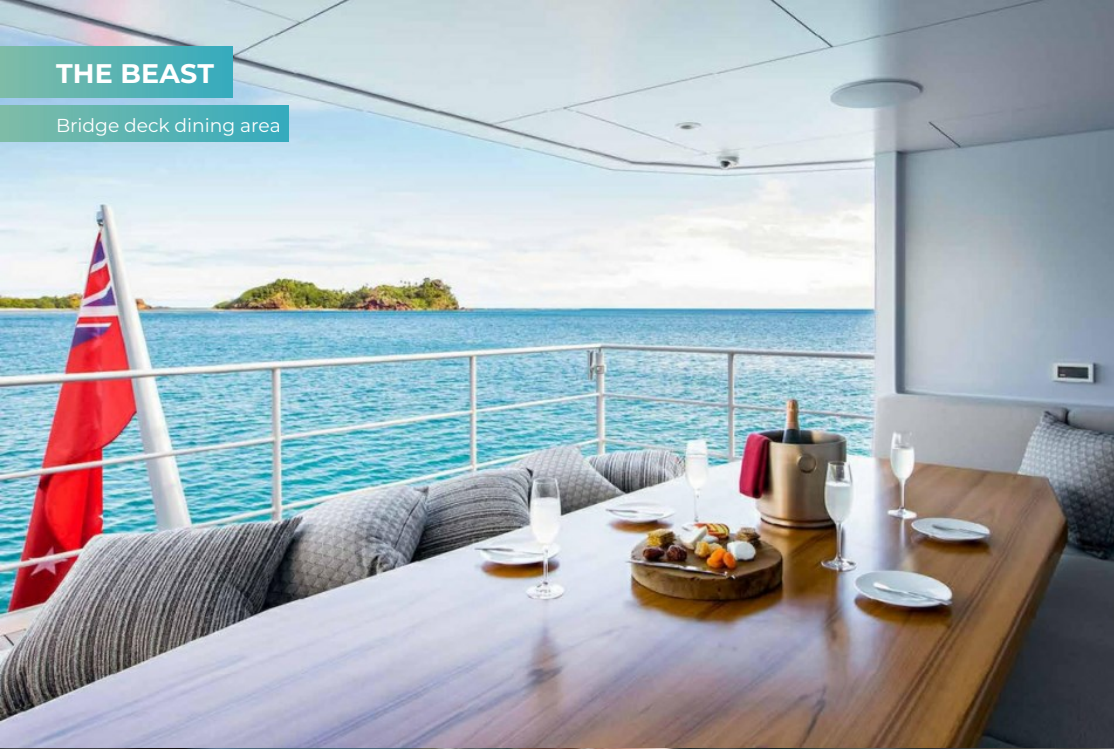

Breakfast set-up



Cocktails



Wheelhouse from the bow



# THE BEAST

Main deck dining area and lounge



Main deck lounge



Main deck dining area



Sky lounge



# THE BEAST

Office and design studio



# Hallway



# Master cabin



# Double cabin



## THE BEAST

Convertible double/twin cabin



Bunk bed cabin



Sports fishing boat



Sports fishing boat



BURGESS

Discover the difference.  
[burgessyachts.com](http://burgessyachts.com)

# THE BEAST

Tender



Toys



Stern view



Cruising



# THE BEAST

At anchor



## THE BEAST

# SPECIFICATION.



Length  
**39,2m (128,6ft)**



Built  
**2019, ProFab Central Engineering Ltd**



Beam  
**12m (39,4ft)**



Draft  
**2,5m (8,2ft)**



Gross tonnage  
**493**



Cruising speed  
**10 knots**



Maximum speed  
**13 knots**



Fuel consumption at cruising speed  
**210 litres per hour**



Guests  
**12**



No. of guest cabins  
**5 (3 × double, 2 × double/twin, 2 × additional berths)**



Crew  
**9**

[View yacht on website](#)

[Watch yacht video](#)



THE BEAST

# TENDERS & TOYS



1 x Towed tender



2 x Tenders



6 x Kayaks



2 x Stand up paddleboards



Pedal board



Wakeboard



Waterskis



Scuba diving equipment



Snorkelling gear



Fishing gear

13m Custom Sports Fisher (Baby Beast), 9.3m Custom Amphibious tender, 4.5m Zodiac, 4 Single kayaks, 2 Double kayaks, 2 SUP's, 1 Schiller Bike (pedal powered Catamaran), Extensive fishing equipment, Water skis, Wake board, 1 x Bauer Poseidon Editon 250, 12 Full sets of SCUBA equipment, 12 tanks, Assortment of wetsuits and snorkelling gear

THE BEAST

# FITNESS & WELLNESS



Free weights



Upright stationary bike



Yoga mats

Yoga mats, Bicycle on the sun deck, Assorted weights.

# THE BEAST

Profile

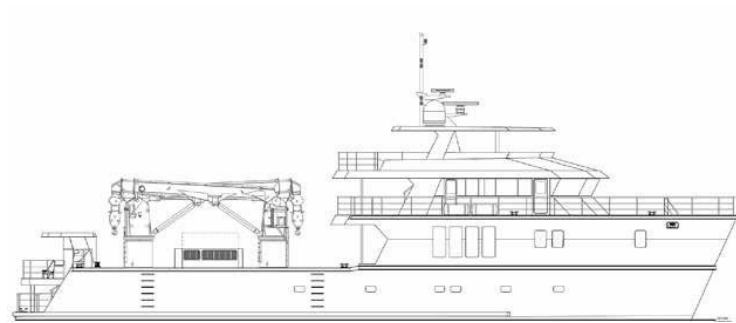

# THE BEAST

Sun deck

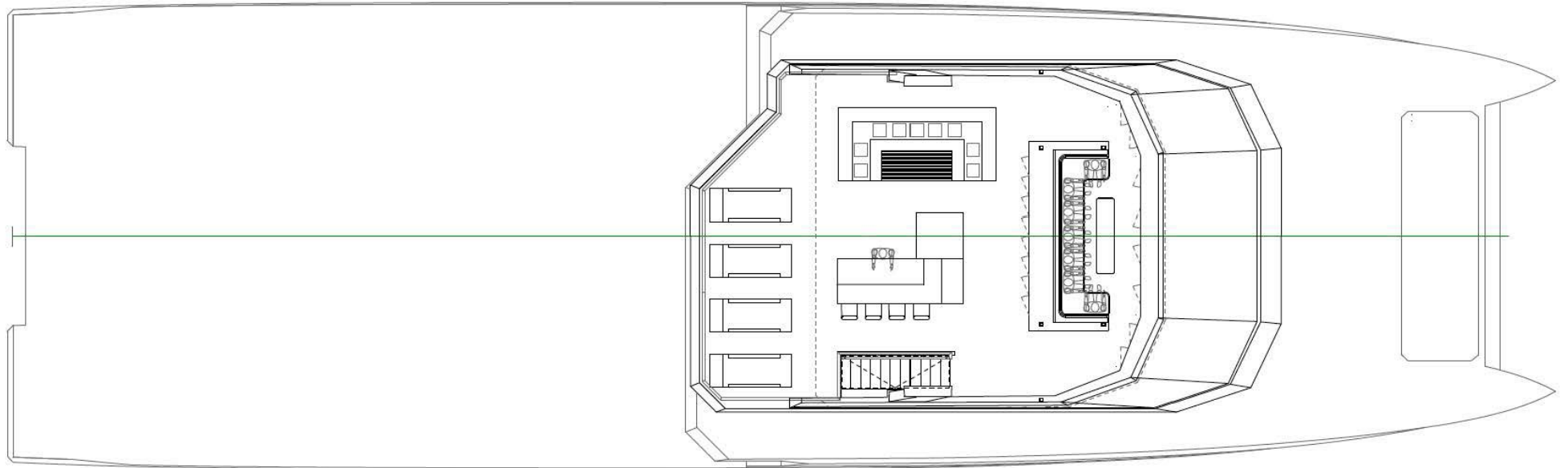

SUN DECK

# THE BEAST

Bridge deck

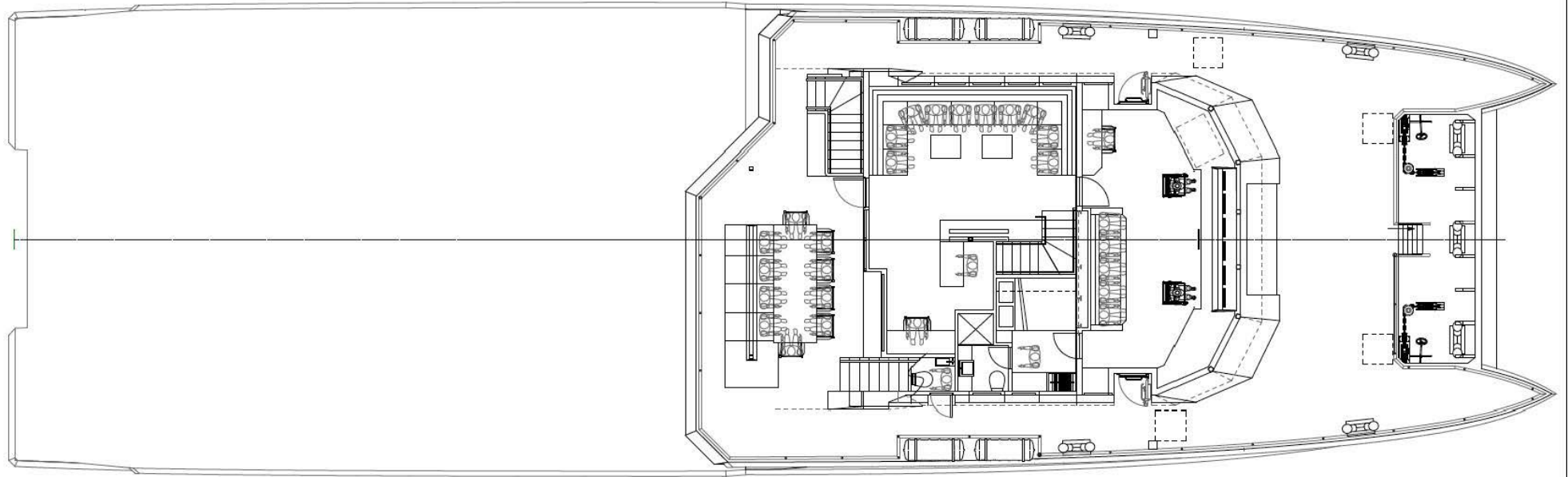

BRIDGE DECK

# THE BEAST

Main deck

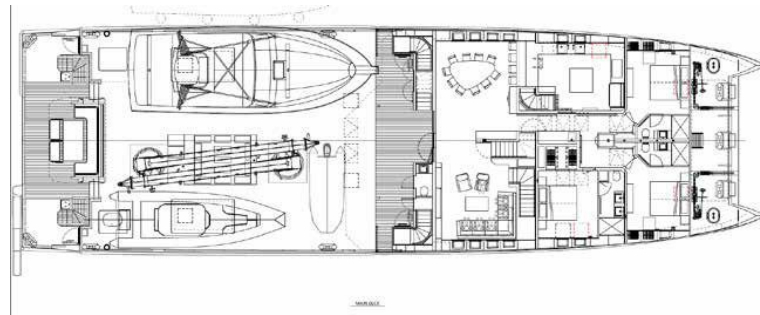

# THE BEAST

Lower deck

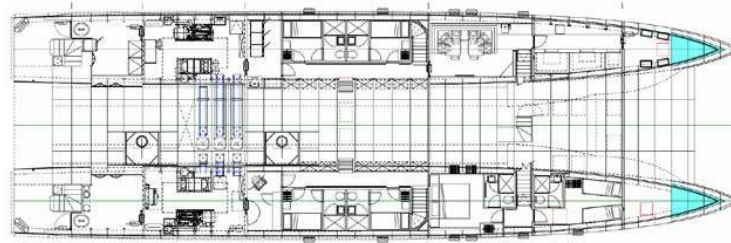

# BURGESS

# WORLD CLASS. WORLD WIDE.

<b>London</b> +44 20 7766 4300	<b>Monaco</b> +377 97 97 81 21	<b>New York</b> +1 212 223 0410	<b>Miami</b> +1 305 672 0150	<b>Singapore</b> +65 9665 8990	<b>Beverly Hills</b> +1 310 424 5112	<b>Palma</b> +34 971 495 413	<b>Athens</b> +30 210 967 1661
<b>Dubai</b> +971 4 425 5874	<b>Phuket</b> +66 7623 9739	<b>Hong Kong</b> +852 6496 2094	<b>Tokyo</b> +81 46 738 8612	<b>Sydney</b> +61 499 945 557	<b>Mumbai</b> +91 98211 67253	<b>Rio de Janeiro</b> +55 21 2553-3238	<b>Shanghai</b> +86 187 0898 6800
<b>Guernsey</b> +44 1481 735360							

Advertising of these vessel(s) in printed publications, on the internet or in any other medium is not permitted without prior written permission from Burgess. All particulars are given in good faith and are believed correct but they cannot be guaranteed.

Last updated: 28 abril 2026