

# TALISMAN MAITON

---



TALISMAN MAITON

# OVERVIEW.

**Boasting an enormous open plan sun deck and an eclectically styled interior with Art Deco features, TALISMAN MAITON is a perennially popular charter yacht.**

Her eye-catching interior blends Asian influences with Art Deco touches to create lavish entertaining spaces that are also supremely comfortable to live in. The more formal main salon and dining area is off-set by the relaxed setting of the sky lounge, with its large, curving corner sofa and wide opening onto the bridge deck aft.

TALISMAN MAITON has fantastic outdoor spaces, with extensive covered seating, al fresco dining areas and a platform above the sun deck offering sensational 360 degree views at sunset. The sun deck was made for sunbathing, with sun pads angled in every direction to catch the sun, and a shaded area mid-ships that houses a bar and dining table. The forward-facing jacuzzi is a pool with a view, and low profile glass shields surround the forward section to provide shelter from the wind. Six individually styled "boutique" cabins provide sumptuous accommodation for 12 guests. The eclectic master suite has an adjoining dressing room, an office and an en suite bathroom with a jacuzzi bath and shower. The VIP cabin is also positioned on the main deck, while the two double and two double/twin convertible cabins (each with a pullman berth) are located on the lower deck.

With an on board gym and plenty of hair-raising watersports equipment, TALISMAN MAITON offers the full superyacht experience.

## Key features

---

**Master and VIP cabins on the main deck**

---

**Office adjoining master cabin**

---

**The twin cabins convert to offer six double cabins in total**

---

**Gym**

---

**Vast sun deck**

---

**Zero speed stabilisers to reduce any rolling motion while at anchor**

---

# TALISMAN MAITON

Main deck lounge



Main deck lounge



Main deck lounge dining



Service



TALISMAN MAITON

Exquisite dining



Main deck lounge bar



Master suite



Master suite



BURGESS

Discover the difference.  
burgessyachts.com

TALISMAN MAITON

Master suite



Master suite



Master suite office



Master suite bathroom



TALISMAN MAITON

VIP cabin



Lower deck lobby



Double cabin



Double cabin



TALISMAN MAITON

Double cabin



Double cabin



Twin/double cabin



Twin/double cabin with pullman berth – twin cabin setup



# TALISMAN MAITON

Twin/double cabin



Twin/double cabin with pullman berth – double cabin setup



Guest cabin shower room en suite



Guest cabin bathroom en suite



# TALISMAN MAITON

Details



Sky lounge



Sky lounge



Games room



# TALISMAN MAITON

Gym



Main deck aft



Bridge deck aft



Bridge deck aft dining



# TALISMAN MAITON

Bridge deck aft dining



Table scape



Sun deck



Sun deck



# TALISMAN MAITON

Sun deck



Sun deck jacuzzi



Sun deck jacuzzi



Sun deck



# TALISMAN MAITON

Sun deck jacuzzi



Crow's nest



Crow's nest and sun deck forward



Sun deck jacuzzi



# TALISMAN MAITON

Foredeck seating



Tender



Embarkation



Main deck aft and swim platform

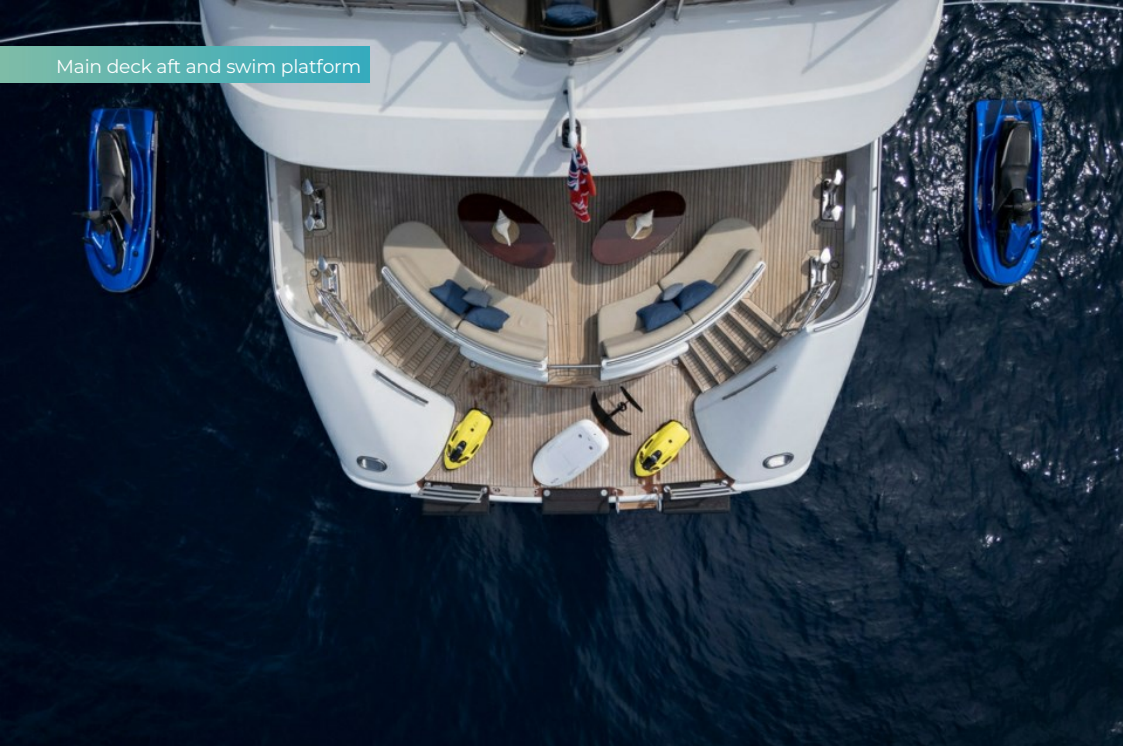

# TALISMAN MAITON

Toys



At anchor



Cruising



TALISMAN MAITON



# TALISMAN MAITON

At anchor



Aerial view



13.9m Axopar 45 Cross Cabin chase tender with 3 x 300hp engines



**BURGESS**

Discover the difference.  
[burgessyachts.com](http://burgessyachts.com)

TALISMAN MAITON

# SPECIFICATION.



Length  
**54,2m (177,8ft)**



Built  
**2006 (refurbished 2012), Proteksan Turquoise, Turkey**



Interior designer  
**H2 Yacht Design**



Beam  
**9,3m (30,5ft)**



Draft  
**3,1m (10,2ft)**



Gross tonnage  
**692**



Cruising speed  
**13 knots**



Maximum speed  
**16 knots**



Fuel consumption at cruising speed  
**230 litres per hour**



Engines  
**2 x 1.500hp Caterpillar**



Generators  
**3**



Guests  
**12**



No. of guest cabins  
**6 (4 x double, 2 x double/twin, 2 x additional berths)**



Crew  
**13**

## Note

Fully licensed for charters in Spanish waters.

[View yacht on website](#)

[Watch yacht video](#)



# TENDERS & TOYS



2 × Tenders



1 × Deck jacuzzi



2 × Waverunners



2 × SeaBobs



2 × Kayaks



2 × Stand up paddleboards



Wakeboard



Kneeboard



Waterskis



Inflatable tows



Snorkelling gear



Fishing gear



RYA training centre for jetskis & waverunners

6.2m Castoldi tender with 260hp engine, 5m Polaris tender with 80hp engine, 2 x Yamaha EX Deluxe 1049cc waverunners (3 man), waterskis, wakeboards, kneeboard & tows, 2 x inflatable stand up paddle boards, 3 x inflatable kayaks (2 man), inflatable lounge, fishing gear, snorkelling gear, approved RYA training centre for guests' use of personal watercraft (jetskis)

TALISMAN MAITON

# FITNESS & WELLNESS



Free weights



Pedal bike



Training bench



Treadmill



Upright stationary bike

Running machine, bicycle, adjustable free weights, adjustable kettlebell, gym bench

# TALISMAN MAITON

Deck plans

UPPER DECK

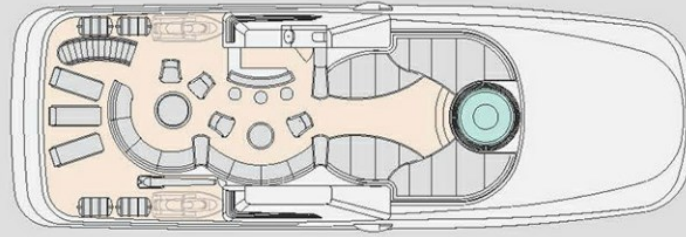

MAIN DECK



LOWER DECK

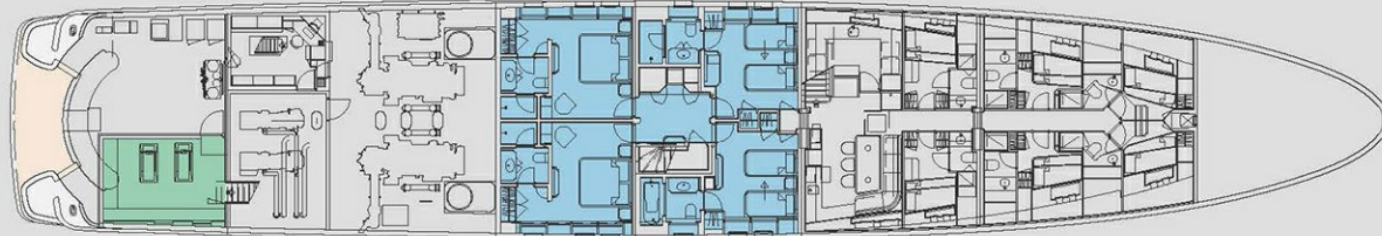

Living Areas

Master Suite

VIP Cabin

Guest Cabins

Gym

Jacuzzi

# BURGESS

# WORLD CLASS. WORLD WIDE.

<b>London</b> +44 20 7766 4300	<b>Monaco</b> +377 97 97 81 21	<b>New York</b> +1 212 223 0410	<b>Miami</b> +1 305 672 0150	<b>Singapore</b> +65 9665 8990	<b>Beverly Hills</b> +1 310 424 5112	<b>Palma</b> +34 971 495 413	<b>Athens</b> +30 210 967 1661
<b>Dubai</b> +971 4 425 5874	<b>Phuket</b> +66 7623 9739	<b>Hong Kong</b> +852 6496 2094	<b>Tokyo</b> +81 46 738 8612	<b>Sydney</b> +61 499 945 557	<b>Mumbai</b> +91 98211 67253	<b>Rio de Janeiro</b> +55 21 2553-3238	<b>Shanghai</b> +86 187 0898 6800
<b>Guernsey</b> +44 1481 735360							

Advertising of these vessel(s) in printed publications, on the internet or in any other medium is not permitted without prior written permission from Burgess. All particulars are given in good faith and are believed correct but they cannot be guaranteed.

Last updated: 28 abril 2026