

# SILVER DREAM

---



SILVER DREAM

# OVERVIEW.

**With her slick silver and black profile SILVER DREAM is instantly recognisable. Known for her sophisticated styling and first-class crew, she is a perennial charter favourite.**

SILVER DREAM ingeniously maximises her interior space with an expansive main saloon and dining area that continue the silver and black theme, accented with striking Aboriginal artwork. The bridge deck sky lounge has a calm, neutral colour scheme and large windows that spill plenty of natural light, making it the ideal place to retreat from the heat of the sun.

The cleverly designed sun deck provides ample seating and sunbathing space under collapsible parasols, while the jacuzzi aft is easily at hand for guests to plunge in and cool off. But, for the ultimate private sunspot, head forward of the bridge and take in the view from the luxurious double sun pad. Kick back with a pre-dinner cocktail on the bridge deck, then let the crew serve a spectacular al fresco dinner at the circular table on the main deck aft.

The supremely spacious full beam master suite incorporates its own saloon, study, dressing room and his and her bathrooms, with gently curved shapes and warm tones creating a peaceful ambience. The rest of the guest accommodation is made up of two double and two twin cabins on the lower deck which provide a welcoming retreat at the end of the day.

SILVER DREAM has an abundance of watertoys, guaranteeing plenty of entertainment on, above and below the waterline.

## Key features

---

**Projector screen in the sky lounge provides on board cinema experience**

---

**Gym**

---

**On board masseuse and spa therapist**

---

**Swim platform/watersports area with an extensive selection of watertoys**

---

**Sun deck jacuzzi**

---

# SILVER DREAM

At anchor



Main deck lounge



Main deck lounge



Dining room



# SILVER DREAM

Main deck atrium



Dining room



Main deck starboard side



Master suite



# SILVER DREAM

Master suite



Master suite office



Master bathroom (hers)



Master shower room (his)



# SILVER DREAM

Double cabin



Guest shower room



Twin cabin



Double cabin



# SILVER DREAM

Twin cabin



Sky lounge



Sky lounge cinema screen



Bridge



# SILVER DREAM

Dining details



Main deck aft



Bridge deck aft



Main deck aft



# SILVER DREAM

Sun deck



Sun deck jacuzzi



Sun deck



Overhead views



# SILVER DREAM

Foredeck



Watersports



Toys



Watersports



SILVER DREAM

Transom



Cruising



At anchor



BURGESS

Discover the difference.  
[burgessyachts.com](http://burgessyachts.com)

SILVER DREAM

# SPECIFICATION.



Length  
**43,8m (143,7ft)**



Built  
**2001 (refurbished 2019), Warren Yachts, Australia**



Interior designer  
**Thomas Hamel/Sam Sorgiovanni**



Beam  
**8,5m (27,9ft)**



Draft  
**2,1m (6,9ft)**



Gross tonnage  
**395**



Cruising speed  
**12 knots**



Maximum speed  
**17,4 knots**



Fuel consumption at cruising speed  
**240 litres per hour**



Engines  
**2 x 1.350hp Caterpillar**



Generators  
**2**



Guests  
**10**



No. of guest cabins  
**5 (3 x double, 2 x twin)**



Crew  
**10**

[View yacht on website](#)

[Watch yacht video](#)



SILVER DREAM

# TENDERS & TOYS



2 × Tenders



1 × Sailing dinghy



1 × Deck jacuzzi



2 × Waverunners



1 × SeaBob



1 × eFoil



2 × Kayaks



2 × Stand up paddleboards



Wakeboard



Kneeboard



Wakesurf



Wakeskate



Waterskis



Inflatable platform



Inflatable toys



Snorkelling gear



Fishing gear



RYA training centre for jetskis & waverunners

5.5m Castoldi jet tender with 125hp engine, 4.5m Rescue tender with 25hp engine, 2 x Sea-Doo Spark Rotax 900 ACE waverunners (2 man), 2 x stand up paddleboards, 2 x inflatable kayaks, waterskis, wakeboard & toys, wakeskate, fishing gear, snorkelling gear, approved RYA training centre for personal watercraft

SILVER DREAM

# FITNESS & WELLNESS



Boxing equipment



Exercise balls



Free weights



Personal trainer



Rowing machine



Suspension trainer



Training bench



Upright stationary bike

# SILVER DREAM

LIVING AREAS

BATHROOMS

OWNER AND GUEST CABINS

Deck plans

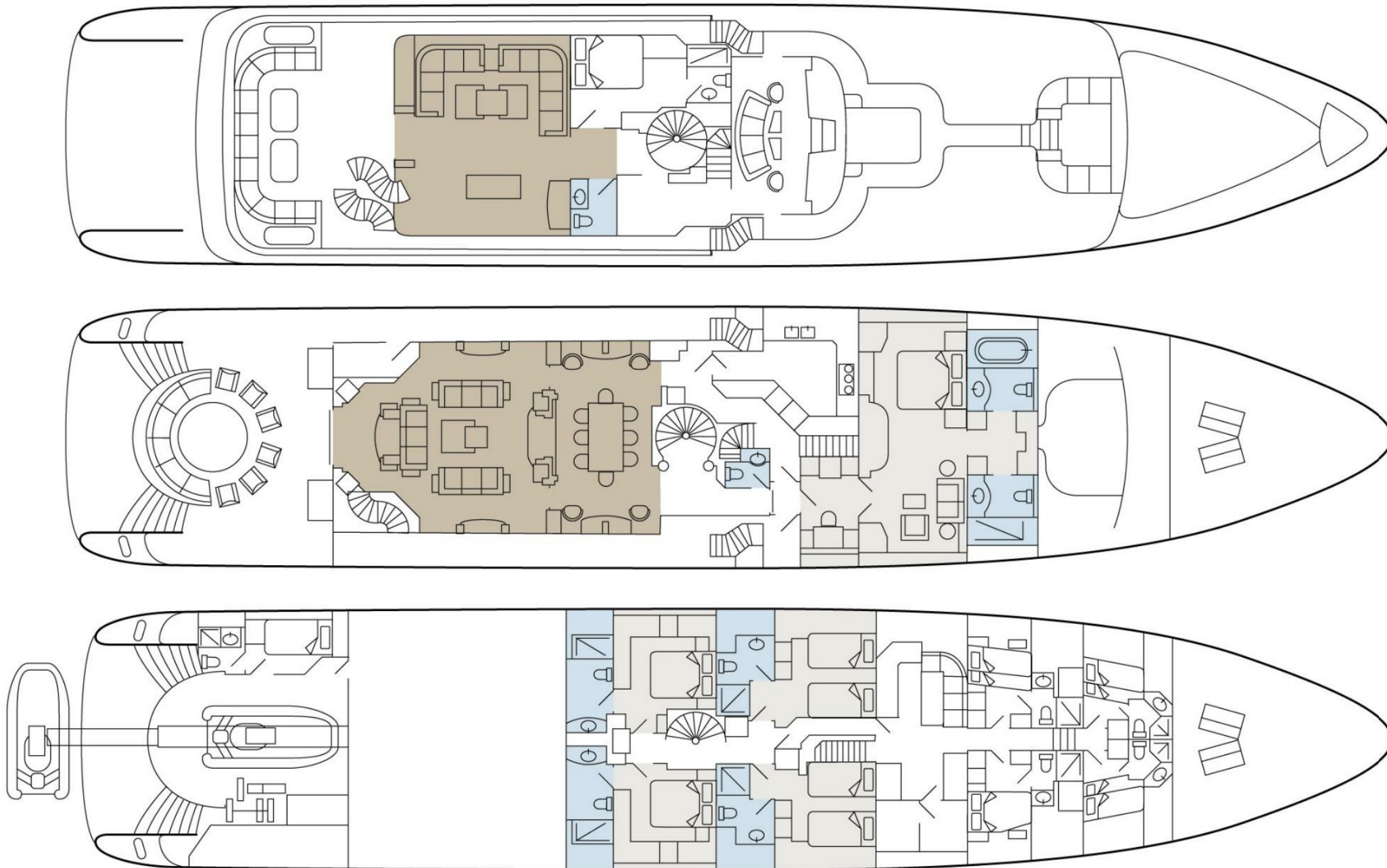

# BURGESS

# WORLD CLASS. WORLD WIDE.

<b>London</b> +44 20 7766 4300	<b>Monaco</b> +377 97 97 81 21	<b>New York</b> +1 212 223 0410	<b>Miami</b> +1 305 672 0150	<b>Singapore</b> +65 9665 8990	<b>Beverly Hills</b> +1 310 424 5112	<b>Palma</b> +34 971 495 413	<b>Athens</b> +30 210 967 1661
<b>Dubai</b> +971 4 425 5874	<b>Phuket</b> +66 7623 9739	<b>Hong Kong</b> +852 6496 2094	<b>Tokyo</b> +81 46 738 8612	<b>Sydney</b> +61 499 945 557	<b>Mumbai</b> +91 98211 67253	<b>Rio de Janeiro</b> +55 21 2553-3238	<b>Shanghai</b> +86 187 0898 6800
<b>Guernsey</b> +44 1481 735360							

Advertising of these vessel(s) in printed publications, on the internet or in any other medium is not permitted without prior written permission from Burgess. All particulars are given in good faith and are believed correct but they cannot be guaranteed.

Last updated: 28 abril 2026