

# RUYA

---



RUYA

# OVERVIEW.

**Delivered in 2016, the 41.4m (135.9ft) motor yacht RUYA is a gleaming gem on the charter market. Guests love her award-winning, thoroughly original and truly outstanding Australian outback-inspired interior by famed designer Sam Sorgiovanni.**

Built to celebrate al fresco living, she has a huge 93sqm (1,001sqft) sun deck complete with bar, BBQ, open-air dining shaded by the hardtop, a glass-fronted 10-person jacuzzi for soaking in the sun and gym equipment for morning workouts. Glass screens keep you draft-free without spoiling the views.

The hydraulic swim platform gives you step-free access to the water and the beach club where you can relax and snack between swims. She has an armada of watertoys to keep everyone's adrenaline levels up and the yacht is also an RYA-approved training centre so you can use the toys without a licence.

Inside, her interior makes use of indigenous material like bamboo and Australian silky oak to create a relaxed, comforting environment. Floor-to-ceiling glass in the main lounge and formal dining room create a remarkable sense of openness and that flows into the main deck aft lounge area. There's shaded open-air dining and a sun lounge on the upper deck aft and inside is a home cinema with an 80in screen and surround sound for movie nights.

She welcomes 10 guests in five finely appointed suites. There is a full-beam master suite forward on the main deck, wonderfully illuminated by large picture windows, with a private office and his-and-hers bathroom with bath and shower area. Two double cabins and two twin cabins on the lower deck complete her accommodation.

This is a yacht that intimately connects her guests to their environment, from the sun deck to the beach club, served by a crew that always gets brilliant feedback. For fans of the great outdoors, look no further than RUYA.

## Key features

---

**Extensive 7-month winter refit 2020-21 elevating her to 'brand-new' condition**

---

**Impressive interior volume of 499GT usually found on much larger yachts**

---

**Generous 93sqm sun deck with large jacuzzi**

---

**Thoroughly original Sam Sorgiovanni interior design**

---

**Vast hydraulic swim platform**

---

**Low fuel consumption**

---

**Zero speed stabilisers to reduce any rolling motion while at anchor**

---

RUYA

Main deck aft



Main deck lounge



Main deck lounge



Main deck dining area



BURGESS

Discover the difference.  
burgessyachts.com

RUYA

Main deck dining area



Main deck master cabin



Main deck master cabin study



Main deck master cabin bathroom en suite



RUYA

Main deck master cabin bathroom en suite



Lower deck double cabin



Lower deck double cabin bathroom en suite



Lower deck twin cabin



RUYA

Lower deck twin cabin bathroom en suite



Upper deck outdoor dining



Sun deck lounge



Sun deck



BURGESS

Discover the difference.  
burgessyachts.com

**RUYA**

Sun deck jacuzzi



Upper deck lounge



Upper deck lounge



Sun deck



**BURGESS**

Discover the difference.  
[burgessyachts.com](http://burgessyachts.com)

RUYA

Beach club



Watersports



Running



BURGESS

Discover the difference.  
[burgessyachts.com](http://burgessyachts.com)

RUYA

# SPECIFICATION.



Length  
**41,4m (135,8ft)**



Built  
**2016 (refitted 2021), Alia Yachts, Turkey**



Interior designer  
**Sam Sorgiovanni**



Beam  
**8,9m (29,2ft)**



Draft  
**2,5m (8,2ft)**



Gross tonnage  
**499**



Cruising speed  
**10 knots**



Maximum speed  
**14 knots**



Fuel consumption at cruising speed  
**120 litres per hour**



Engines  
**2 x 1.000hp Caterpillar**



Generators  
**2**



Guests  
**10**



No. of guest cabins  
**5 (3 x double, 2 x double/twin, 2 x additional berths)**



Crew  
**8**

## Note

Not available for charter to US residents while in US waters.

[View yacht on website](#)

[Watch yacht video](#)



RUYA

# TENDERS & TOYS



1 x Tender



1 x Deck jacuzzi



2 x Waverunners



2 x SeaBobs



3 x Kayaks



3 x Stand up paddleboards



Wakeboard



Waterskis



Inflatable tows



Scuba diving equipment



Snorkelling gear



RYA training centre for jetskis & waverunners

7.9m Century chase tender with 2 x 150hp engine (Available only in the Caribbean), 5.8m Novurania chase tender with diesel jet Yanmar 260hp engine, 3.6m AB Navigo VS inflatable tender with Evinrude 25hp outboard engine, 2 x Sea-Doo RXT-X 300 (3 man), 2 x SeaBobs F5S, 2 x inflatable kayaks, Waterskis, wakeboards, 3 x stand up paddle boards, 6 x towables, Snorkelling gear, Approved RYA training centre for guests

RUYA

# FITNESS & WELLNESS



Free weights



Upright stationary bike



Yoga mats

Stationary bike, weights, kettle bells, yoga mats

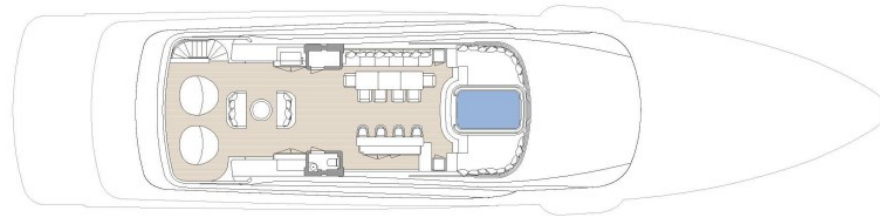

SUN DECK



UPPER DECK



MAIN DECK

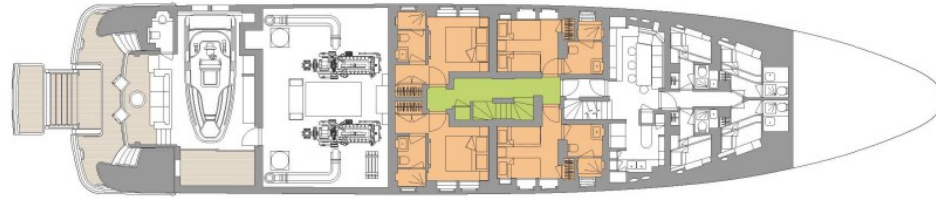

LOWER DECK

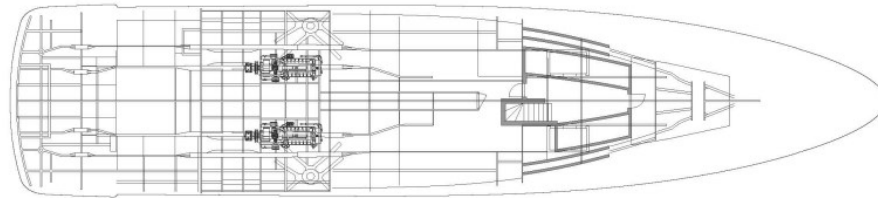

BOTTOM DECK

■ GUEST AREAS ■ MASTER SUITE ■ GUEST CABINS ■ MASTER SUITE OFFICE ■ JACUZZI

# BURGESS

# WORLD CLASS. WORLD WIDE.

<b>London</b> +44 20 7766 4300	<b>Monaco</b> +377 97 97 81 21	<b>New York</b> +1 212 223 0410	<b>Miami</b> +1 305 672 0150	<b>Singapore</b> +65 9665 8990	<b>Beverly Hills</b> +1 310 424 5112	<b>Palma</b> +34 971 495 413	<b>Athens</b> +30 210 967 1661
<b>Dubai</b> +971 4 425 5874	<b>Phuket</b> +66 7623 9739	<b>Hong Kong</b> +852 6496 2094	<b>Tokyo</b> +81 46 738 8612	<b>Sydney</b> +61 499 945 557	<b>Mumbai</b> +91 98211 67253	<b>Rio de Janeiro</b> +55 21 2553-3238	<b>Shanghai</b> +86 187 0898 6800
<b>Guernsey</b> +44 1481 735360							

Advertising of these vessel(s) in printed publications, on the internet or in any other medium is not permitted without prior written permission from Burgess. All particulars are given in good faith and are believed correct but they cannot be guaranteed.

Last updated: 28 abril 2026