

# LETHANTIA

---



LETHANTIA

# SPECIFICATION.



Asking price  
**EUR 8.250.000 (EU VAT paid)**



Built  
**1994 (refitted 2019), Royal Huisman Shipyard,  
The Netherlands**



Length  
**43,9m (144ft)**



Beam  
**8,7m (28,4ft)**



Draft min/max  
**-/4m (13,1ft)**



Displacement  
**225 tonnes**



Cruising speed  
**10 knots**



Maximum speed  
**13 knots**



Flag  
**Cayman Islands**



Lying  
**Europe**



Exterior designer  
**Lunstroo Custom Design**



Interior designer  
**John Munford**



Construction  
**Hull - Aluminium, Superstructure - Aluminium,  
Deck - Teak**



Crew  
**6**



Guests  
**6**



Cabins  
**3 (1 × double, 2 × twin)**



Engines  
**1 × 650hp MTU**

## Note

Not available for sale to US residents while in US waters.

[View yacht on website](#)



LETHANTIA



BURGESS

Discover the difference.  
[burgessyachts.com](http://burgessyachts.com)

LETHANTIA



BURGESS

Discover the difference.  
[burgessyachts.com](http://burgessyachts.com)

LETHANTIA



BURGESS

Discover the difference.  
[burgessyachts.com](http://burgessyachts.com)

LETHANTIA



BURGESS

Discover the difference.  
[burgessyachts.com](http://burgessyachts.com)

LETHANTIA



BURGESS

Discover the difference.  
[burgessyachts.com](http://burgessyachts.com)

LETHANTIA

# OVERVIEW.

**The 43.9m (144ft) schooner LETHANTIA was built in aluminium and delivered in 1994 by revered Dutch shipyard Royal Huisman. Naval architecture and exterior design are by Lunstroo Custom Design and interiors are by the celebrated British designer John Munford. A 2017 refit saw the yacht repainted with Awlgrip. Further works were carried out in 2019 and she comes to market with new teak decks, new sails and a new PLC monitoring system. Having been professionally operated, maintained and serviced since delivery, she presents in excellent condition.**

A pleasing sheer arcs from her wineglass stern to her 4m bowsprit and there is plenty of versatile deck space to enjoy once at anchor. Cockpit seating for her six guests is shaded by a collapsible bimini.

Steps lead down into the deckhouse where there is saloon dining to port and seating to starboard, an opening skylight to illuminate the cabinetry and views out onto the anchorage. From there steps lead forward into the main saloon where there is a formal dining area to port and a lounge area to starboard, cocooned in teak and cherry wood, again lit by a generous opening skylight.

She accommodates six guests. The full beam owner's suite, reconfigured in 2017 to include a king size double berth, is aft, down steps from the deckhouse. It is en suite and two large decklights provide natural light. Forward of the main saloon are two double cabins, also en suite and each with a decklight. She also sleeps six crew in quarters forward with separate deck access.

Two aluminium masts by Rondal carry 720sqm (7,750sqft) of sails, by North Sails and Hood and all sails are handled by modern hydraulic operated furlers, captive drum and reel winches so she is easily managed by a shorthanded crew. In calms a single 650hp MTU diesel engine gives her a top speed of 13 knots and a cruising speed of 10 knots.

## Key features

---

**A modern classic schooner designed to be easily sailed**

---

**Comfortable voluminous interior**

---

**Classic John Munford interior design**

---

**Fantastic Dutch pedigree**

---

**Fully redesigned master cabin**

---

**New teak/sails and PLC monitoring system**

---

## Tenders

---

1 x Williams 505 diesel jet, 1 x Avon Sea sport jet 320

# MAIN DECK

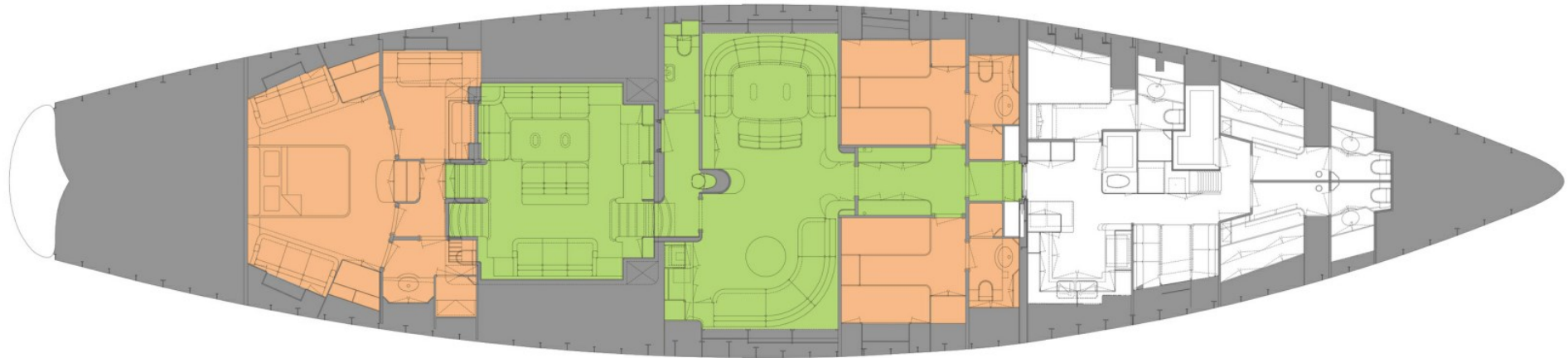

 GUEST AREAS  GUEST CABINS

# BURGESS

# WORLD CLASS. WORLD WIDE.

<b>London</b> +44 20 7766 4300	<b>Monaco</b> +377 97 97 81 21	<b>New York</b> +1 212 223 0410	<b>Miami</b> +1 305 672 0150	<b>Singapore</b> +65 9665 8990	<b>Beverly Hills</b> +1 310 424 5112	<b>Palma</b> +34 971 495 413	<b>Athens</b> +30 210 967 1661
<b>Dubai</b> +971 4 425 5874	<b>Phuket</b> +66 7623 9739	<b>Hong Kong</b> +852 6496 2094	<b>Tokyo</b> +81 46 738 8612	<b>Sydney</b> +61 499 945 557	<b>Mumbai</b> +91 98211 67253	<b>Rio de Janeiro</b> +55 21 2553-3238	<b>Shanghai</b> +86 187 0898 6800
<b>Guernsey</b> +44 1481 735360							

Advertising of these vessel(s) in printed publications, on the internet or in any other medium is not permitted without prior written permission from Burgess. All particulars are given in good faith and are believed correct but they cannot be guaranteed.

Last updated: 28 abril 2026