

KOGO



KOGO

SPECIFICATION.



Asking price
GBP 30.000.000



Built
2006, Alstom Leroux Naval Shipyard, France



Length
71,7m (235,3ft)



Beam
13,5m (44,3ft)



Draft
3,8m (12,5ft)



Gross tonnage
1.892



Cruising speed
15 knots



Maximum speed
17 knots



Flag
Cayman Islands



Lying
USA



Class
**Lloyd's Register (LR) Lloyd's Register, 100A1,
SSC YACHT (P) MONO G6 UMS+LMC G6 ICE
Class 1B, MCA Compliant**



Exterior designer
Tim Heywood



Interior designer
Terence Disdale



Construction
**Hull - Steel, Superstructure - Aluminium, Deck
- Teak**



Crew
21



Guests
14



Cabins
7 (5 x double, 2 x twin)



Engines
2 x 2.145hp ABB Azipod Drives



Generators
4



Propulsion
Twin screw diesel yacht

Note

Not available for sale to US residents while in US waters.

[View yacht on website](#)



KOGO

Cruising



Upper deck lounge



Upper deck lounge



Upper deck bar



BURGESS

Discover the difference.
burgessyachts.com

KOGO

Upper deck lounge



Main deck corridor



Main deck lounge



Main deck lounge



BURGESS

Discover the difference.
burgessyachts.com

KOGO

Main deck lounge cinema set-up



Main deck lounge



Main deck dining area



Main deck dining area



BURGESS

Discover the difference.
burgessyachts.com

OVERVIEW.

KOGO is a 71.7m (235.2ft) yacht with an ice-classed steel hull and aluminium superstructure built to Lloyd's classification and MCA compliance, and delivered by French shipyard Alstom Leroux Naval in 2006. Her exterior design is by Tim Heywood, Terence Disdale Design created her interiors and naval architecture is by Burness Corlett Three Quays. The result of an extraordinary collaboration, KOGO won the World Superyacht of the Year award in 2007.

Her sun deck has a large jacuzzi forward flanked by sun pads and sheltered by glass screens, and aft there is an al fresco dining area with bar, sheltered by sliding screens either side and more sun pads aft. Her bridge deck saloon offers a variety of social spaces with a bar, gaming table and lounge area, with sliding glass doors opening out onto a large sun lounge for relaxation or entertainment. This space also doubles as an outdoor cinema with world class Dolby surround sound.

Her main deck has a versatile formal dining room to port, seating two tables of eight or one table of 16, all enjoying excellent views out through large picture windows. To starboard is the main saloon, which doubles as a state-of-the-art entertainment centre with Dolby surround sound and a HD cinema screen. From the aft main deck steps lead down to a fold-down swim platform and a large beach club area well suited to parties.

Disdale describes KOGO's interiors as 'clean modern lines with a Zen influence' and there is a calming aura of balance on board as one descends to the lower deck, where guests can work out in a well-equipped gym, sweat it out in a steam room, freshen up in a shower room before enjoying a soothing rub down in the massage room.

The spacious owner's suite is forward on the main deck. The bedroom is to starboard and there is a lounge-study area to port with his and hers walk-in wardrobes and a bathroom forward with his and hers wash and shower facilities and a shared bath. She has two double cabins on the main deck and, on the lower deck, two further double cabins and two twin cabins complete versatile accommodation for 14, attended to by up to 21 crew.

Diesel electric propulsion is provided by twin Caterpillar 3512B engines driving two ABB Azipod drives, new in 2016, that together with the Brunvoll bowthruster enable dynamic positioning. She has a top speed of 17kn, a cruising speed of 15kn and a range of 5,000nm at 11kn. Four Quantum zero speed stabilisers ensure stability at anchor and there is a helideck for access in remote locations.

Key features

Lloyd's 15 year special survey complete in 2021

14 guests in 7 staterooms, including a master suite, 4 double cabins and 2 twin cabins

Helipad / ICE Class 1B

Diesel electric propulsion with twin Caterpillar engines & Azipods

Interior design by Terence Disdale

Exterior design by Tim Heywood

World Superyacht of the Year Award 2007

Fantastic audio visual systems including cinema in main deck lounge and on bridge deck aft

Steam room and sauna

Tenders

1 x 7.9m (26ft) Yachtwerft fully enclosed Limousine tender with 2 x 120hp engines, 1 x Towed 8.2m (27ft) Ribtec tender with 360hp engine 1 x 6.1m (20ft) rescue boat Ribtec tender with 120hp engine

GENERAL ARRANGEMENT

KEY: MAIN SALOON R, BRIDGE DECK SALOON ■ SALOON/STUDY ■ DINING ROOM ■ BATHROOMS ■ ACCOMMODATION ■ STEAM ROOM ■ MASSAGE ROOM ■ GYM ■

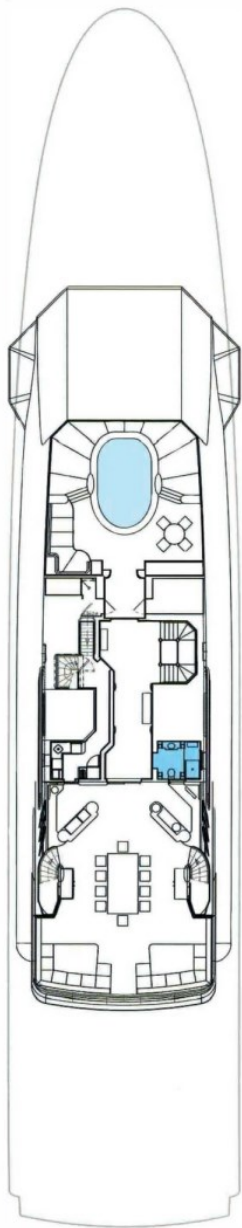

SUN DECK



BRIDGE DECK



MAIN DECK



LOWER DECK

BURGESS

WORLD CLASS. WORLD WIDE.

London +44 20 7766 4300	Monaco +377 97 97 81 21	New York +1 212 223 0410	Miami +1 305 672 0150	Singapore +65 9665 8990	Beverly Hills +1 310 424 5112	Palma +34 971 495 413	Athens +30 210 967 1661
Dubai +971 4 425 5874	Phuket +66 7623 9739	Hong Kong +852 6496 2094	Tokyo +81 46 738 8612	Sydney +61 499 945 557	Mumbai +91 98211 67253	Rio de Janeiro +55 21 2553-3238	Shanghai +86 187 0898 6800
Guernsey +44 1481 735360							

Advertising of these vessel(s) in printed publications, on the internet or in any other medium is not permitted without prior written permission from Burgess. All particulars are given in good faith and are believed correct but they cannot be guaranteed.

Last updated: 28 abril 2026