

H



H SPECIFICATION.

 Asking price
EUR 16.500.000

 Built
2023, Azimut, Italy

 Length
35,2m (115,5ft)

 Beam
7,5m (24,6ft)

 Draft
1,9m (6,2ft)

 Gross tonnage
279

 Cruising speed
18 knots

 Maximum speed
22 knots

 Flag
United Kingdom

 Lying
West Mediterranean

 Class
RINA Services S.p.A. (RINA) RINA Rules for Classification of Pleasure Yachts, Class Notation C \boxtimes HULL · MACH Y

 Exterior designer
Alberto Mancini

 Interior designer
Alberto Mancini

 Construction
Hull - GRP, Superstructure - GRP, Deck - Teak

 Crew
6

 Guests
10

 Cabins
5 (3 × double, 2 × twin)

 Engines
2 × 2.200hp MTU

 Propulsion
Twin screw diesel yacht

[View yacht on website](#)

[Watch yacht video](#)



H

Main deck lounge



Main deck lounge



Main deck dining area



Master cabin



H

Master cabin



Master en suite bathroom



Sky lounge



Sky lounge



H

Foredeck



Foredeck pool



Sun deck



Sun deck



H

Bridge deck aft



Bridge deck aft



Main deck aft



Beach club



H

Bow



BURGESS

Discover the difference.
burgessyachts.com

H

OVERVIEW.

The 35.3m (115.7ft) GRANDE 36M features a highly efficient displacement-to-planing hull form, reducing fuel consumption and emissions by up to 30 percent compared to standard hull designs. She is of GRP and carbon fibre construction and built to RINA classification by the Italian shipyard Azimut. Her exterior design is by Alberto Mancini and Achille Salvagni styled her interiors, giving her all-Italian flair.

On the sun deck is a wet bar and U-shaped bench seating beneath the hardtop with a sun lounge aft. The upper deck aft has two lounging areas, one beneath the overhang and another in full sun, as well as a buffet bar. To port the sidedeck leads to a foredeck lounge with seating, a large sunpad and a glass jacuzzi.

The main deck aft has an al fresco lounge with a sofa and chaise longue seating that is served by a wet bar. Steps aft lead down to the large swim platform and beach club with rain shower, while the starboard sidedeck leads up to the foredeck lounge.

An open-plan main saloon has two lounge areas, one with sofa seating the other with armchairs and huge picture windows combining with cut-down bulwarks to deliver exceptional views. The upper deck has the wheelhouse forward with a formal dining area aft surrounded by floor-to-ceiling glass that slides away to open the space on three sides.

The 36M TRIDECK welcomes 10 guests in five cabins. There are four en suite guest cabins on the lower deck; two double VIP suites aft and two twin cabins forward of them. Forward of the guest suites is the crew mess and accommodation for five crew.

Forward on the main deck is the owner's suite, with huge picture windows either side. It features an island king-sized double berth, a lounge area, and en suite with shower room forward. Aft of the owner's suite, the galley and dayhead are off the lobby.

The 36M TRIDECK has a tender garage with a shell door to starboard that can accommodate a tender and PWC. Twin 2,200hp MTU diesel engines give her a cruising speed of 17 knots and a maximum speed of 21 knots. There is an option of upgrading to two 2,400hp MTU engines, increasing these to 18 knots and 24 knots respectively. The yacht also has zero speed stabilisers for comfort at anchor.

Key features

Brand new Azimut 36 Grande, under full warranty

Highly efficient displacement-to-planing hull form, reducing fuel consumption and emissions by up to 30 percent

Oversized glass jacuzzi on the foredeck

Accommodation for 10 guests in five spacious cabins

Large tender garage with starboard side access

Beach club

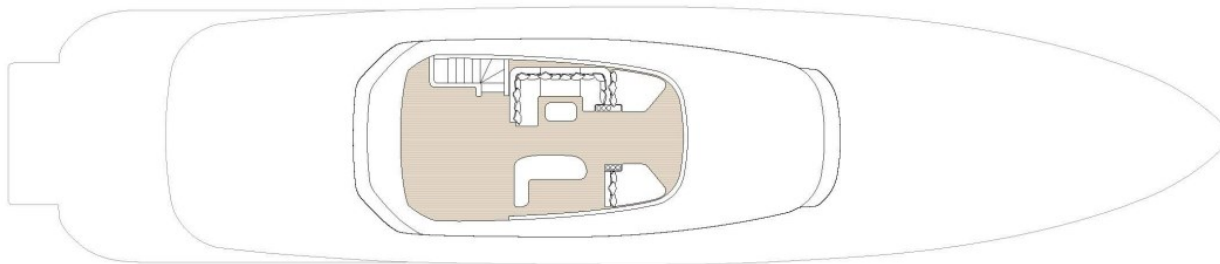

SUN DECK

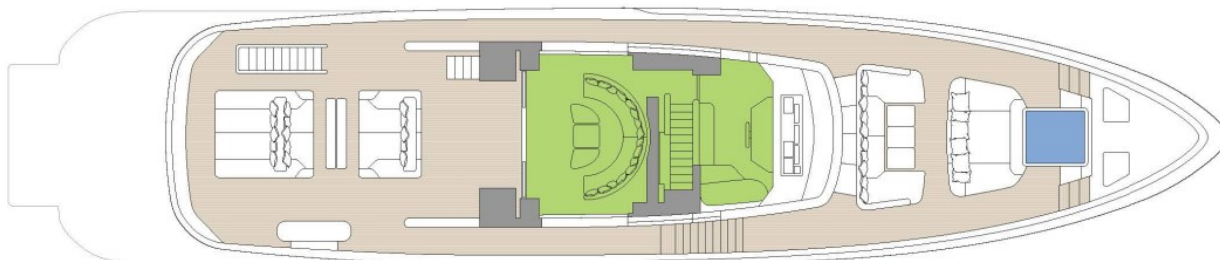

SKY LOUNGE

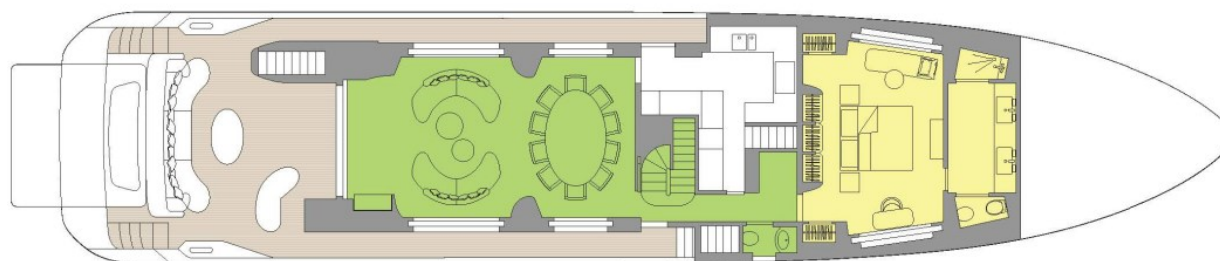

MAIN DECK



LOWER DECK

■ GUEST AREAS ■ MASTER SUITE ■ GUEST CABINS ■ JACUZZI

BURGESS

WORLD CLASS. WORLD WIDE.

London +44 20 7766 4300	Monaco +377 97 97 81 21	New York +1 212 223 0410	Miami +1 305 672 0150	Singapore +65 9665 8990	Beverly Hills +1 310 424 5112	Palma +34 971 495 413	Athens +30 210 967 1661
Dubai +971 4 425 5874	Phuket +66 7623 9739	Hong Kong +852 6496 2094	Tokyo +81 46 738 8612	Sydney +61 499 945 557	Mumbai +91 98211 67253	Rio de Janeiro +55 21 2553-3238	Shanghai +86 187 0898 6800
Guernsey +44 1481 735360							

Advertising of these vessel(s) in printed publications, on the internet or in any other medium is not permitted without prior written permission from Burgess. All particulars are given in good faith and are believed correct but they cannot be guaranteed.

Last updated: 28 abril 2026