

# HEMISPHERE

---



HEMISPHERE

# OVERVIEW.

**For those looking for something different to the standard charter, something more exciting and adventurous, something unforgettably special that celebrates the ocean and its inhabitants without sacrificing seven-star comfort and service, congratulations. You have just found your next charter.**

HEMISPHERE, the world's largest sailing catamaran, is designed to deliver incredible experiences. She has a PADI-certified, Nitrox-capable dive centre for up to 12 guests and Captain Gavin is a qualified dive instructor with encyclopaedic knowledge and infectious passion for marine life in this divers' paradise. There is a 16.4m (53.8ft) sports fishing tender for exploring ashore and reaching special dive sites as well as tournament-standard fishing capabilities.

With a 16.6m (54.5ft) beam, her deck spaces are vast. From her flybridge jacuzzi and al fresco dining areas to her shaded spaces on the main deck aft and the sunbathing trampoline forward where you can watch dolphins play underway, she covers every base for relaxation and entertainment. Two VIP cabins on the main deck each have access to a terrace lounge forward and her award-winning interiors are refined yet instantly welcoming.

HEMISPHERE and her crew live to the maxim 'Sometimes you have to step off the beaten path, for the bigger rewards in life' and relentlessly glowing feedback from delighted guests means they deliver those rewards every time.

'Wow! Once again Captain Gavin you have exceeded our expectations! Our trip was full of surprises and adventure. Truly the best holiday a family could dream of sharing. Thank you for welcoming us back and we look forward to returning next year.'

'You are all amazing. We had such a fabulous week on board, everything about the charter was wonderful. The hospitality of the entire crew was unforgettable, I can't wait to be part of this experience again!'

'I have been on many boats in my 57 years and this holiday has surpassed all of them. The crew are the best we have been with. Sharks, whales, dolphins, sunsets, cocktails, laughter, loads of love -thank you Gavin and crew.'

## Key features

---

**Designed for off the beaten track exploration**

---

**Two principal suites**

---

**Included in price: 16.4m Custom Sports Fishing tender for shore excursions, diving and fishing trips**

---

**Certified PADI dive training centre with two dive instructors as part of the crew - guests can become PADI certified whilst on board**

---

**Large jacuzzi on the sun deck**

---

**Sport tournament standard fishing equipment**

---

**Long standing crew with outstanding charter record**

---

**Unrivalled deck and interior space in 499 GT**

---

# HEMISPHERE

Trampoline



Main deck aft seating area



Main deck aft dining area



Main deck aft dining area



HEMISPHERE

Main deck aft dining area



Main deck lounge



Main deck lounge



Main deck games room



# HEMISPHERE

Main deck games room



Main deck VIP cabin



Main deck second VIP cabin



VIP shower room en suite



# HEMISPHERE

VIP shower room en suite



Lower deck twin cabin with two pullman beds



Detail



Flybridge jacuzzi

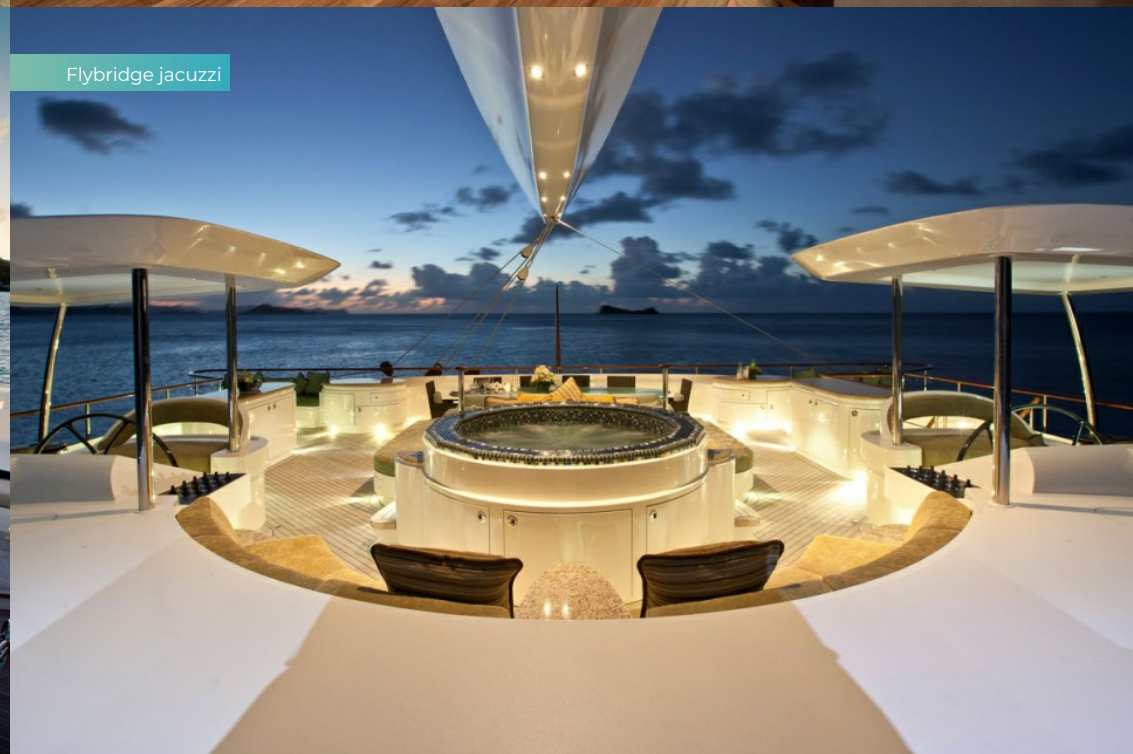

# HEMISPHERE

Flybridge dining area and sun pads



Sports fishing boat



Watersports



Stern view



HEMISPHERE

# SPECIFICATION.



Length  
**44,2m (145ft)**



Built  
**2011 (refitted 2023), Pendennis Shipyard, United Kingdom**



Interior designer  
**Michael Leach Design**



Beam  
**16,6m (54,5ft)**



Draft min/max  
**-/3,1m (10,2ft)**



Displacement  
**499 tonnes**



Cruising speed  
**11 knots**



Maximum speed  
**13 knots**



Fuel consumption at cruising speed  
**230 litres per hour**



Engines  
**2 x 490hp Caterpillar**



Guests  
**10/12**



No. of guest cabins  
**5 (4 x double, 1 x twin, 2 x additional berths)**



Crew  
**10**

## Note

Not available for charter to US residents while in US waters.

[View yacht on website](#)

[Watch yacht video](#)



HEMISPHERE

# TENDERS & TOYS



1 x Towed tender



2 x Tenders



1 x Sailing dinghy



1 x Deck jacuzzi



4 x SeaBobs



1 x Kayak



1 x Stand up paddleboard



Windsurfer



Wakeboard



Kneeboard



Waterskis



Trampoline



Aquapark



Inflatable platform



Diving board



Inflatable tows



Dive centre



Scuba diving equipment



Snorkelling gear



Fishing gear

Certified PADI dive centre, 16.4m F&S Custom sports fishing boat with 2 x 1150hp engines, 8.2m Scorpion tender with 400hp engine, 4.5m Castoldi jet tender with 125hp, full scuba diving facilities for 12 guests, 4 x SeaBobs, windsurfers, kayak, waterskis, wakeboard, kneeboards & tows, stand up paddleboard, 4.8m inflatable water trampoline, inflatables, 0.5m high 2.4m professional diving board, snorkelling gear, sports tournament standard fishing equipment

HEMISPHERE

# FITNESS & WELLNESS



Free weights



Yoga mats

Yoga mats, free weights, jacuzzi

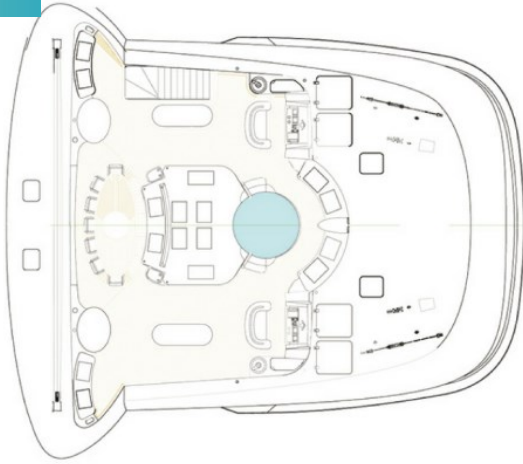

FLYBRIDGE

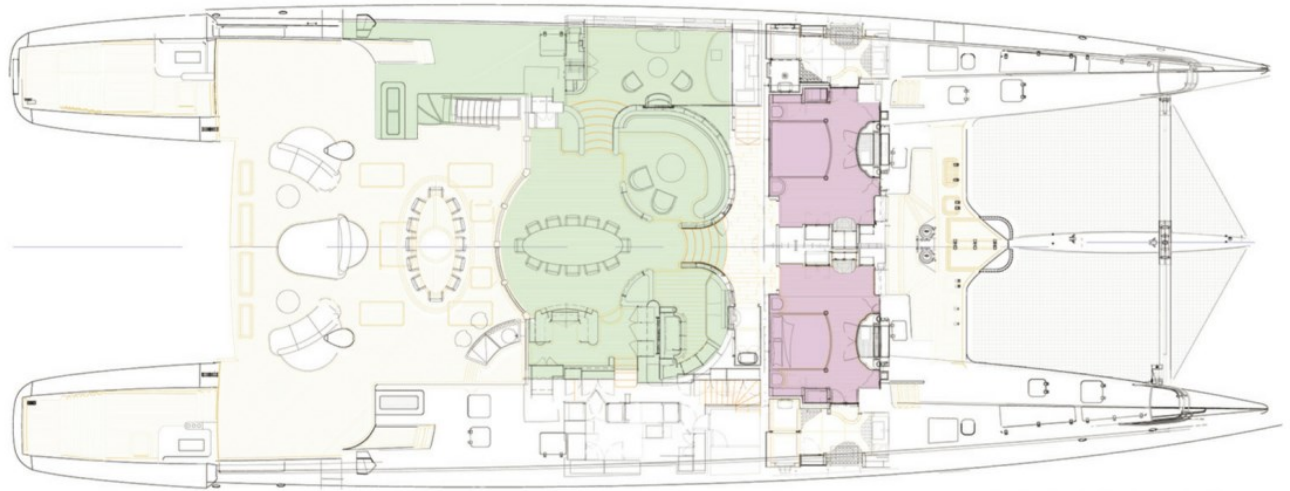

MAIN DECK

KEY:

- Living Areas
- Master/VIP Cabins
- Guest Cabins
- Jacuzzi
- Dive Locker

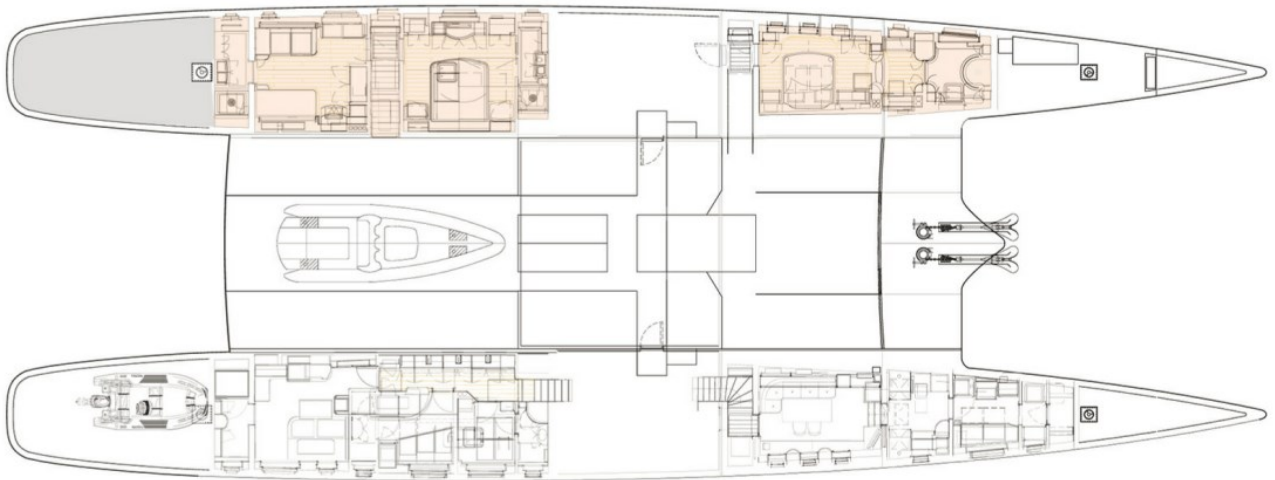

CABIN DECK

# BURGESS

# WORLD CLASS. WORLD WIDE.

<b>London</b> +44 20 7766 4300	<b>Monaco</b> +377 97 97 81 21	<b>New York</b> +1 212 223 0410	<b>Miami</b> +1 305 672 0150	<b>Singapore</b> +65 9665 8990	<b>Beverly Hills</b> +1 310 424 5112	<b>Palma</b> +34 971 495 413	<b>Athens</b> +30 210 967 1661
<b>Dubai</b> +971 4 425 5874	<b>Phuket</b> +66 7623 9739	<b>Hong Kong</b> +852 6496 2094	<b>Tokyo</b> +81 46 738 8612	<b>Sydney</b> +61 499 945 557	<b>Mumbai</b> +91 98211 67253	<b>Rio de Janeiro</b> +55 21 2553-3238	<b>Shanghai</b> +86 187 0898 6800
<b>Guernsey</b> +44 1481 735360							

Advertising of these vessel(s) in printed publications, on the internet or in any other medium is not permitted without prior written permission from Burgess. All particulars are given in good faith and are believed correct but they cannot be guaranteed.

Last updated: 28 abril 2026