

G-FORCE



G-FORCE

OVERVIEW.

Speed. Space. Style. That's what you get when you charter the award-winning G-FORCE.

With a top speed of 31 knots and a cruising speed of 22 knots, this aptly-named sports flybridge yacht is the consummate island-hopper. She will expand your cruising range and the potential of your holiday, as you can go further and see more in the same time, as well as cutting a clean wake on the way.

On arrival the 5.5m Nautica tender continues the speed theme as its 285hp engine lets you explore, get ashore or enjoy the exhilarating tow toys. There's also a three-seater Sea-Doo jetski to add to the high-speed thrills.

Sleeping eight in five cabins, including a full-beam master cabin on the bridge deck, she offers her guests plenty of space. There are sun pads surrounding the sun deck jacuzzi, aft of the shaded lounges, more sun pads on the foredeck and well deck seating where you can feel the adrenaline with the wind in your hair, before enjoying a sundowner at anchor as the sun sets on another day of amazing adventures.

As for style, she is all about high contrast, with the theme of her black-and-white exterior being reflected in Jean-Pierre Gilardino's clean-lined interior, which he described to Boat International as 'simple, contemporary, chic and sophisticated - in essence the style is contemporary with Art Deco touches.' Gilardino's inspired design was recognised with the Interior Design category in the World Superyacht Awards 2007.

Chief among these 1930s touches is the bathroom in the master cabin, where the bevelled mirror and the wall lights perfectly frame the cinematic glamour of the age. Another highlight is the Macassar ebony dining table beneath a Murano-glass chandelier, surrounded by a semi-circle of sliding glass that opens onto the main deck aft.

With six experienced and professional crew to take care of guests' every need, G-FORCE always delivers unforgettable memories of amazing charters.

Key features

Maximum speed of 32 knots, perfect for thrill-seeking clients!

Charismatic Captain Lars leads a long-standing crew and highly-skilled crew

Constantly maintained to extremely high standard, in immaculate condition

G-FORCE

Underway



Main deck lounge



Main deck saloon



Main deck lounge



BURGESS

Discover the difference.
burgessyachts.com

G-FORCE

Main deck dining area



Main deck lounge and bar



Main deck dining area



Master cabin



G-FORCE

Guest double cabin



Master cabin study



Master cabin en suite



Guest double cabin



G-FORCE

Guest double cabin



Guest cabin en suite



Cruising



BURGESS

Discover the difference.
burgessyachts.com

G-FORCE

SPECIFICATION.



Length
37,3m (122,3ft)



Built
2006, Heesen, The Netherlands



Interior designer
Jean-Pierre Gilardino



Beam
7,5m (24,6ft)



Draft
2,2m (7,2ft)



Gross tonnage
245



Cruising speed
22 knots



Maximum speed
31 knots



Fuel consumption at cruising speed
220 litres per hour



Engines
2 x 3.648hp MTU



Generators
2



Guests
8



No. of guest cabins
5 (4 x double, 1 x twin, 2 x additional berths)



Crew
6

Note

Fully licensed for charters in Spanish waters. Not available for charter to US residents while in US waters.

[View yacht on website](#)

[Watch yacht video](#)



G-FORCE

TENDERS & TOYS



1 x Tender



1 x Deck jacuzzi



1 x Stand up jetski



1 x Kayak



Wakeboard



Waterskis



Inflatable toys

5.5m Nautica jet tender with 285hp engine, 1 x Sea-Doo waverunner (3 man) jetski, kayak, waterskis & toys

G-FORCE

Deck plans

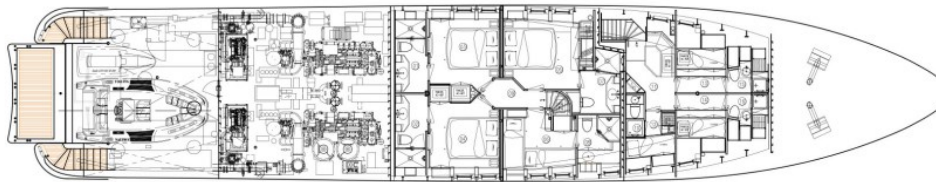
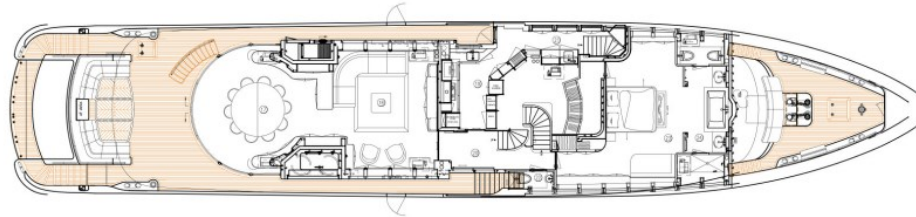
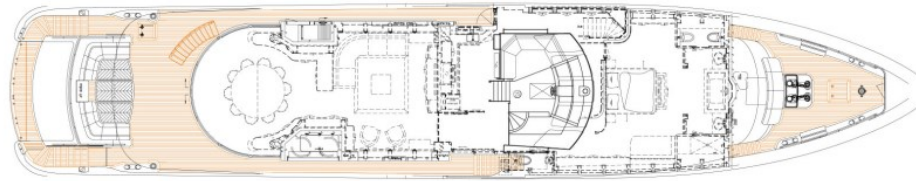
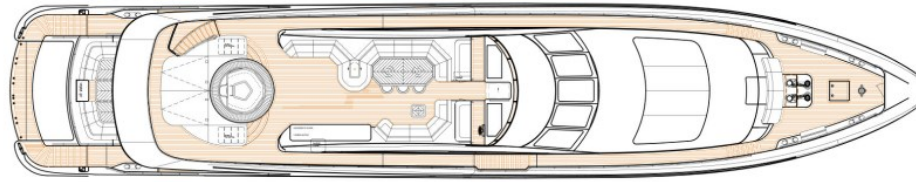
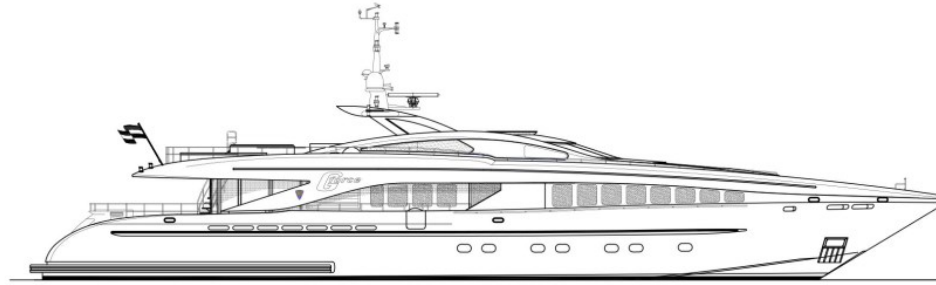

BURGESS

WORLD CLASS. WORLD WIDE.

London +44 20 7766 4300	Monaco +377 97 97 81 21	New York +1 212 223 0410	Miami +1 305 672 0150	Singapore +65 9665 8990	Beverly Hills +1 310 424 5112	Palma +34 971 495 413	Athens +30 210 967 1661
Dubai +971 4 425 5874	Phuket +66 7623 9739	Hong Kong +852 6496 2094	Tokyo +81 46 738 8612	Sydney +61 499 945 557	Mumbai +91 98211 67253	Rio de Janeiro +55 21 2553-3238	Shanghai +86 187 0898 6800
Guernsey +44 1481 735360							

Advertising of these vessel(s) in printed publications, on the internet or in any other medium is not permitted without prior written permission from Burgess. All particulars are given in good faith and are believed correct but they cannot be guaranteed.

Last updated: 28 abril 2026