

ESTHER 7



ESTHER 7

SPECIFICATION.



Asking price
USD 7.880.000



Built
2014, Horizon Yachts, Taiwan



Length
33,5m (110ft)



Beam
7,6m (25ft)



Draft
1,8m (6ft)



Gross tonnage
227



Cruising speed
15 knots



Maximum speed
18 knots



Flag
Panama



Lying
Asia



Exterior designer
Espinosa Yacht Design



Interior designer
Espinosa Yacht Design



Construction
Hull - GRP, Superstructure - GRP, Deck - Teak



Guests
10



Cabins
5 (3 × double, 2 × double/twin)



Engines
2 × 1.800hp Caterpillar



Propulsion
Twin screw diesel yacht

[View yacht on website](#)



ESTHER 7

Main saloon



Main saloon



Dining



Master cabin



ESTHER 7

VIP cabin



Twin guest cabin



Utility room



Bridge



ESTHER 7

Main aft



Sun deck



BURGESS

Discover the difference.
burgessyachts.com

ESTHER 7

OVERVIEW.

The 33.5m (110ft) motor yacht ESTHER 7, from Horizon Yachts' popular RP110 series, was constructed in fibreglass with naval architecture by Don Blount and contemporary interiors and exteriors by Espinosa Yachts Design. She was delivered in 2014.

The large sun deck has a deck crane for launching tender and toys, sunlounging deck space and a raised jacuzzi aft, and beneath the hardtop there is L-shaped seating around two tables port and starboard as well as a bar and BBQ. Forward there is forward facing seating to port, a flybridge helm station to starboard and behind a central sliding door are steps leading to the bridge, which has guest seating.

The main deck aft has open-air dining and a drop-down TV. Steps either side lead down to the large swim platform, which is used for toy stowage underway, and the tender garage, which also has internal access from the main deck aft. Walkaround sidedecks lead forward to a Portuguese bridge and large sunpad and full-height sliding glass doors open into the main saloon. Inside the main saloon, which has huge picture windows, is a fully equipped bar, making the main deck aft well suited to entertainment. There is an L-shaped lounge opposite a pop-up TV, a formal dining area forward and a dayhead off the main lobby.

The owner's suite, forward on the main deck, is well lit through large windows port and starboard and two circular skylights. There is a walk-in wardrobe and steps forward lead down to a marble bathroom with shower and bath. On the lower deck are two double guest suites and two twin guest suites, both of which have an additional berth, completing accommodation for 12 guests in five suites.

Twin 1,800hp Caterpillar diesel engines give her a top speed of 18 knots and a cruising speed of 15 knots.

Key features

Very low engine and generator hours

Modern interior design

Stabilized at anchor and underway

Light use

Yearly maintenance undergone thoroughly

SUN DECK

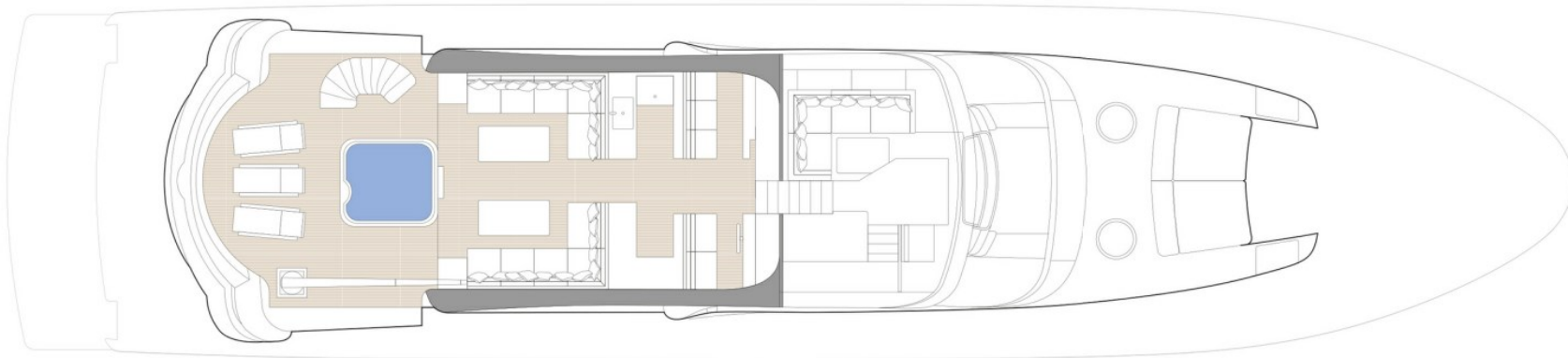

- GUEST AREAS
- OWNER'S SUITE
- GUEST CABINS
- JACUZZI

MAIN DECK



- GUEST AREAS
- OWNER'S SUITE
- GUEST CABINS
- JACUZZI

LOWER DECK

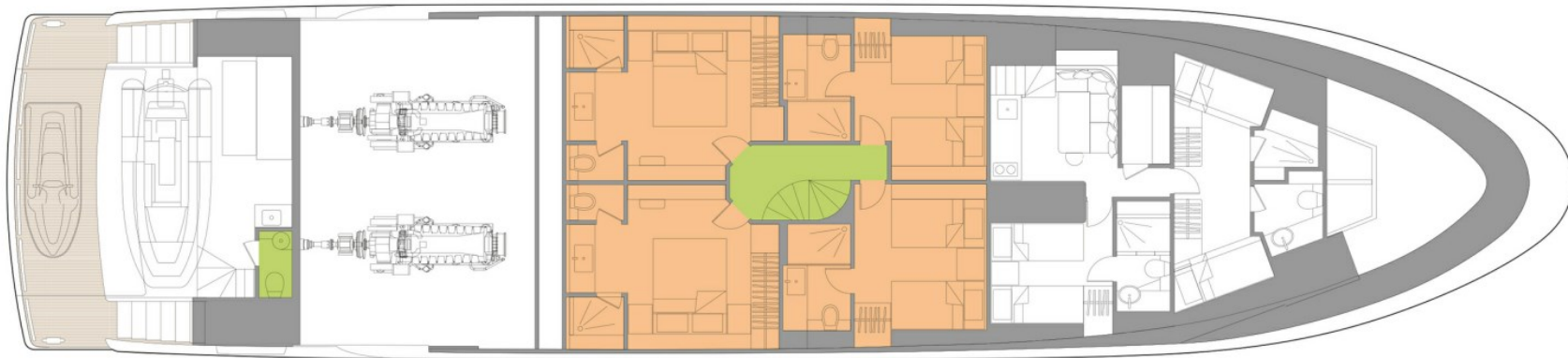

- GUEST AREAS
- OWNER'S SUITE
- GUEST CABINS
- JACUZZI

BURGESS

WORLD CLASS. WORLD WIDE.

London +44 20 7766 4300	Monaco +377 97 97 81 21	New York +1 212 223 0410	Miami +1 305 672 0150	Singapore +65 9665 8990	Beverly Hills +1 310 424 5112	Palma +34 971 495 413	Athens +30 210 967 1661
Dubai +971 4 425 5874	Phuket +66 7623 9739	Hong Kong +852 6496 2094	Tokyo +81 46 738 8612	Sydney +61 499 945 557	Mumbai +91 98211 67253	Rio de Janeiro +55 21 2553-3238	Shanghai +86 187 0898 6800
Guernsey +44 1481 735360							

Advertising of these vessel(s) in printed publications, on the internet or in any other medium is not permitted without prior written permission from Burgess. All particulars are given in good faith and are believed correct but they cannot be guaranteed.

Last updated: 28 abril 2026