

CLASSIC 40M BENETTI



CLASSIC 40M BENETTI

SPECIFICATION.



Asking price
EUR 6.000.000



Built
1970 (refitted 2022), Benetti, Italy



Length
39,5m (129,6ft)



Beam
7,4m (24,3ft)



Draft
3m (9,8ft)



Gross tonnage
267



Cruising speed
11 knots



Maximum speed
13 knots



Flag
United Kingdom



Lying
West Mediterranean



Class
Bureau Veritas (BV) Bureau Veritas



Exterior designer
Benetti



Construction
Hull - Steel, Superstructure - Steel



Crew
7



Guests
8



Cabins
4 (2 x double, 2 x twin)



Propulsion
Twin screw diesel yacht

[View yacht on website](#)

[Watch yacht video](#)



CLASSIC 40M BENETTI





CLASSIC 40M BENETTI



BURGESS

Discover the difference.
burgessyachts.com



CLASSIC 40M BENETTI



CLASSIC 40M BENETTI



CLASSIC 40M BENETTI



CLASSIC 40M BENETTI



BURGESS

Discover the difference.
burgessyachts.com

OVERVIEW.

A handsome yacht with a first-class pedigree, CLASSIC 40M BENETTI is a 39.5m (129.5ft) tri-deck motor yacht constructed in steel with aluminium superstructure and delivered by the renowned Italian shipyard in 1970. Her long-standing owner has kept a tight maintenance schedule, ensuring that each winter the yacht is refitted and refurbished as needed.

Exterior design details include a graceful sheer line and bow profile, a classic canoe stern, full walkaround sidedecks on two levels and traditional varnished teak capping rails. Covered companionways on the main deck feature Benetti's signature sculpted mullions.

The sun deck has L-shaped sofa seating and a huge expanse of sunpads with partial shade from a fixed awning and exercise equipment forward either side of the funnel. There is another large sunpad forward on the bridge deck and steps down to cushioned seats overlooking the foredeck.

She has a spacious bridge deck aft with shaded open-air dining beneath the sun deck overhang and a sun lounge with a sofa, armchairs and a coffee table opposite two sun loungers. There's a sociable seating area aft that serves as a second open-air dining option with a U-shaped banquette, folding armchairs, a large high-gloss varnished table and a folding canvas bimini.

The main deck aft has four large rattan armchairs around a coffee table in ample shade. Inside, her interior decor is traditional, with finely crafted features. The main deck saloon has a large lounge area aft with L-shaped sofas and two armchairs and forward is the formal dining area with an eight-seat table. The sky lounge has a large sofa facing aft, looking through double doors opening onto the upper aft deck.

Welcoming up to eight guests in four cabins with seven crew, CLASSIC 40M BENETTI offers 267GT of internal volume. The guest accommodation is arranged across two decks. The owner's suite is forward on the main deck, has an office desk and a 10sqm (108sqft) walk-in wardrobe. The en suite has a bathtub as well as a shower. The other guest cabins are on the lower deck, comprising a full-beam VIP double forward and two twin cabins that each have extra pullman berths.

This twin-screw yacht is powered by twin 624hp Caterpillar diesel engines with low engine hours. Her top speed is 13.7kts and she cruises at 11.5kts with a maximum range of 3,600nm.

Key features

Steel hull and Aluminium superstructure

Classic yacht with canoe stern

Lovingly maintained and refitted

Cruising ready

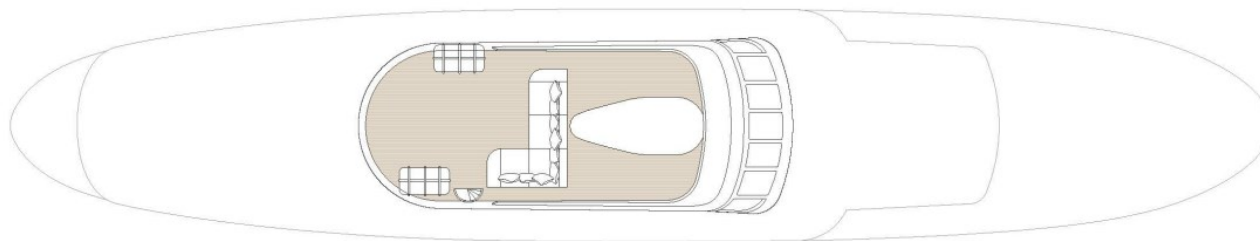

SUN DECK

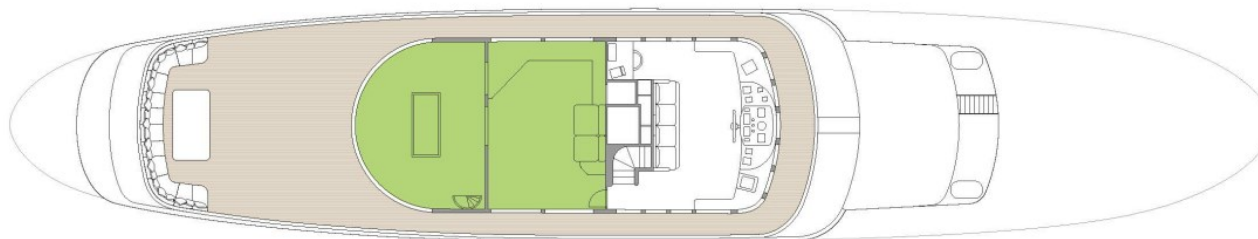

BRIDGE DECK



MAIN DECK

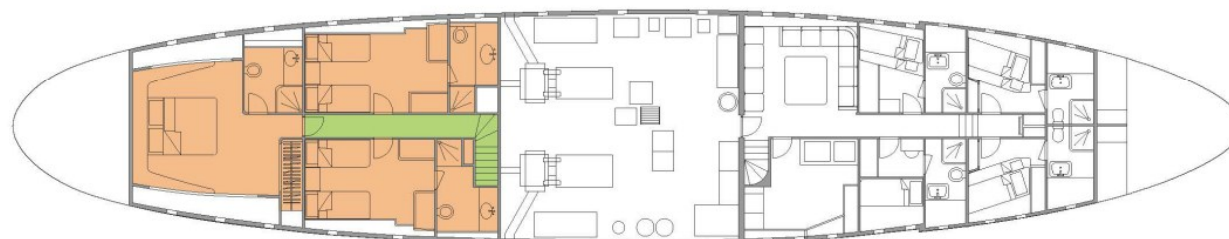

BELOW DECK

■ GUEST AREAS ■ MASTER SUITE ■ GUEST CABINS

BURGESS

WORLD CLASS. WORLD WIDE.

London +44 20 7766 4300	Monaco +377 97 97 81 21	New York +1 212 223 0410	Miami +1 305 672 0150	Singapore +65 9665 8990	Beverly Hills +1 310 424 5112	Palma +34 971 495 413	Athens +30 210 967 1661
Dubai +971 4 425 5874	Phuket +66 7623 9739	Hong Kong +852 6496 2094	Tokyo +81 46 738 8612	Sydney +61 499 945 557	Mumbai +91 98211 67253	Rio de Janeiro +55 21 2553-3238	Shanghai +86 187 0898 6800
Guernsey +44 1481 735360							

Advertising of these vessel(s) in printed publications, on the internet or in any other medium is not permitted without prior written permission from Burgess. All particulars are given in good faith and are believed correct but they cannot be guaranteed.

Last updated: 28 abril 2026