

BLUE II



BLUE II

OVERVIEW.

Designed to evoke the carefree heyday of gentlemen's yachting, this modern classic will turn heads and win hearts in any anchorage. However, her retro chic disguises a yacht at the cutting edge of comfort and technology, with hybrid propulsion for lower emissions, vibration and fuel costs. She is an exquisite blend of yachting's spirit of freedom and state of the art features.

You awake in one of two master suites, one on the upper deck with 180 degree views forward and the other on the main deck. Head for the upper deck aft for a delicious breakfast before settling in the sun lounge aft to discuss the day's plans with the captain. If the morning heat is too intense, start the day in the air conditioned main saloon at the formal dining table and make plans in the lounge opposite.

After breakfast, the children race eagerly down to the portside swim platform where the deck crew has prepared all the watertoys for a morning adrenaline rush. Other guests may choose to work out in the gym, or for an easier start to the day, head for the sauna and hammam where there is a massage table too.

In the afternoon, while the captain sails you to the next amazing destination, enjoy a movie in the main deck cinema lounge or catch up on some emails in the private owner's office on the bridge deck.

As dusk falls in your new anchorage, take in the spectacular sunset with a sundowner in the foredeck lounge and toast another amazing day before sampling the chef's gastronomic extravaganza on the upper deck aft.

Key features

2021 World Superyacht Awards winner of best displacement yacht between 500 and 999 GT

Winner of 2021 BOAT Design & Innovation Awards for outstanding exterior design

Two beautifully appointed master cabins

Spa area with a sauna, steam room and exercise equipment

Timeless interior styling by Vickers Studio and Hoek Design

Hydraulic swim platform for ease of accessing the water

Two large tenders and wide array of watersports

Hybrid propulsion ensuring reduced emissions

BLUE II

Aerial view



Sky lounge



Sky lounge



Master cabin I



BLUE II

Master bathroom en suite



Master office



Master cabin II



Master cabin II



BLUE II

Main deck lounge & dining area



Main deck interior dining



Main deck lounge



Main deck lounge



BLUE II

Double cabin



Sauna



Hamam



Gym



BLUE II

Double cabin



Twin cabin



Upper deck aft



Upper deck aft



BLUE II

Sun deck



Exterior dining



Swim platform



Aerial view



BURGESS

Discover the difference.
burgessyachts.com

BLUE II

SPECIFICATION.



Length
55,9m (183,4ft)



Built
2020, Turquoise Yachts, Turkey



Interior designer
Hoek & Vickers Studio



Beam
9,5m (31,2ft)



Draft
3,7m (12,1ft)



Gross tonnage
706



Cruising speed
10 knots



Maximum speed
12,5 knots



Fuel consumption at cruising speed
170 litres per hour



Engines
2 x 874hp Caterpillar



Guests
12



No. of guest cabins
6 (4 x double, 1 x double/twin, 1 x twin)



Crew
11

Note

Not available for charter to US residents while in US waters.

[View yacht on website](#)

[Watch yacht video](#)



BLUE II

TENDERS & TOYS



1 × Towed tender



1 × Tender



2 × Sailing dinghies



1 × Waverunner



2 × SeaBobs



2 × eFoils



2 × Kayaks



2 × Stand up paddleboards



Wakeboard



Wakesurf



Waterskis



Inflatable tows



Scuba diving equipment



Snorkelling gear



Fishing gear

9.5m Novurania Chase 31, 7m Pascoe Solas tender, Sea-Doo Spark waverunners (2 man), 2 x SeaBob F5, 2 x Tiwal sailing dinghies, Lift E Foil 5.6, Lift E Foil 6.0, 2 x inflatable kayaks, 2 x Jobe Desna 10.0 inflatable stand up paddle boards, wakeboards, Jobe towable Lunar Biscuit (3 man), waterskis, wakesurf, snorkelling gear, fishing gear

DECK 1 – LOWER DECK

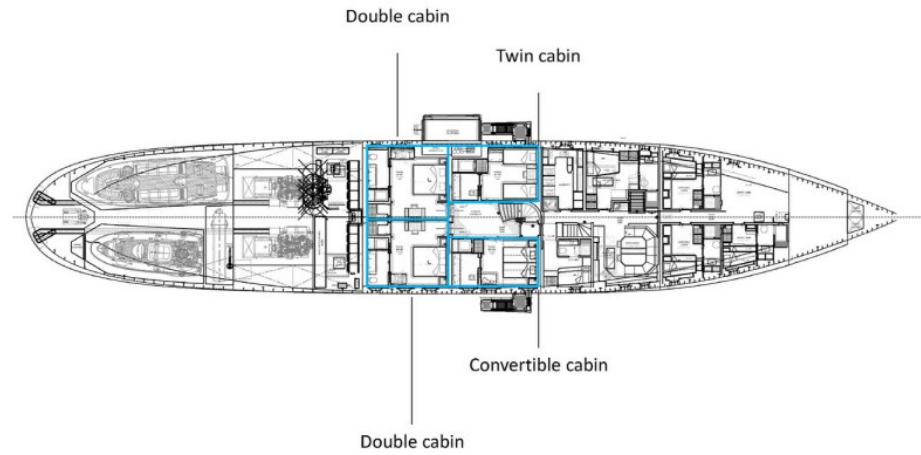

DECK 2 – MAIN DECK

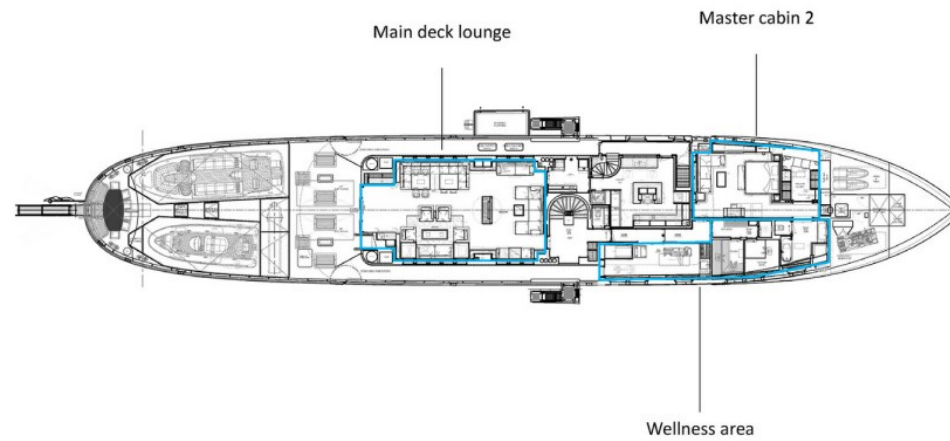

DECK 3 – UPPER DECK

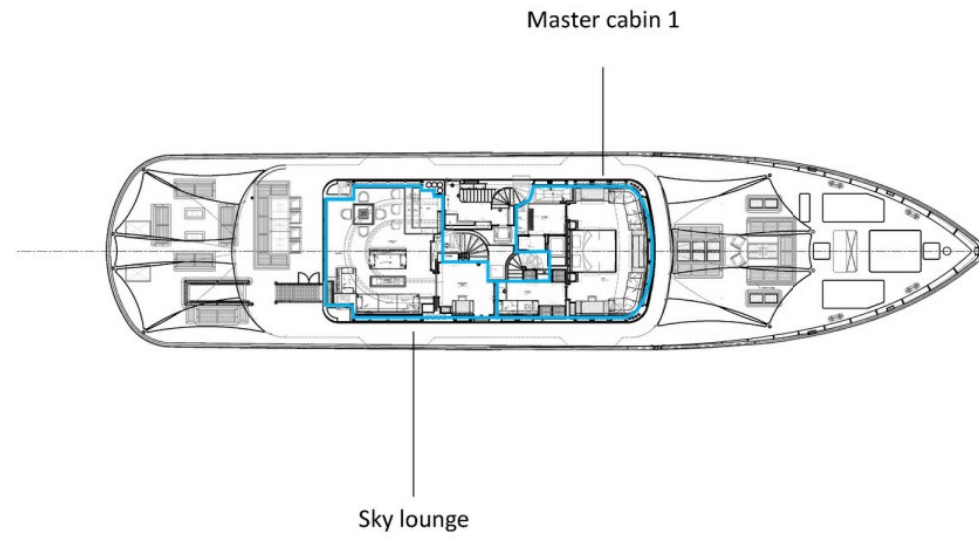

DECK 4 – BRIDGE DECK

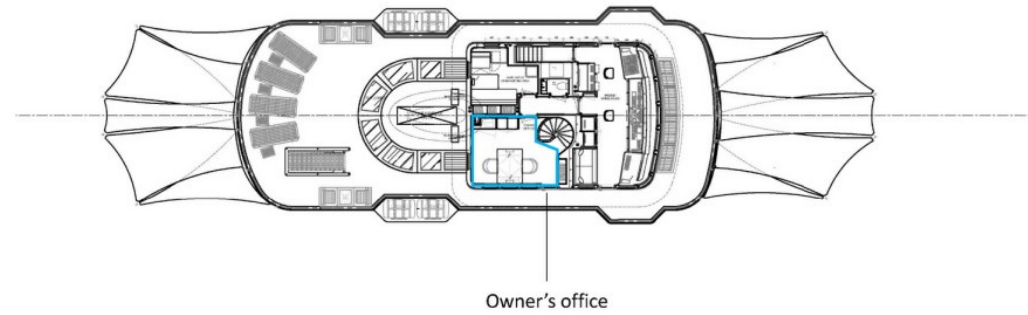

BURGESS

WORLD CLASS. WORLD WIDE.

London +44 20 7766 4300	Monaco +377 97 97 81 21	New York +1 212 223 0410	Miami +1 305 672 0150	Singapore +65 9665 8990	Beverly Hills +1 310 424 5112	Palma +34 971 495 413	Athens +30 210 967 1661
Dubai +971 4 425 5874	Phuket +66 7623 9739	Hong Kong +852 6496 2094	Tokyo +81 46 738 8612	Sydney +61 499 945 557	Mumbai +91 98211 67253	Rio de Janeiro +55 21 2553-3238	Shanghai +86 187 0898 6800
Guernsey +44 1481 735360							

Advertising of these vessel(s) in printed publications, on the internet or in any other medium is not permitted without prior written permission from Burgess. All particulars are given in good faith and are believed correct but they cannot be guaranteed.

Last updated: 28 abril 2026