

BLINK



BLINK

SPECIFICATION.



Asking price
EUR 7.250.000



Built
2009, Cantieri di Pisa, Italy



Length
41m (134,5ft)



Beam
7,7m (25,3ft)



Draft
2,4m (7,9ft)



Gross tonnage
310



Cruising speed
18 knots



Maximum speed
24 knots



Flag
USA



Lying
East Mediterranean



Class
**American Bureau of Shipping (ABS) ABS + A1
Yachting Service AMS**



Exterior designer
Carlo Galeazzi



Interior designer
Cristiano Gatto Design



Construction
Hull - GRP, Superstructure - GRP, Deck - Teak



Crew
8



Guests
11



Cabins
**5 (2 × double, 1 × twin, 2 × single, 3 × additional
berths)**



Engines
2 × 3.648hp MTU



Generators
2



Propulsion
Twin screw diesel yacht

[View yacht on website](#)



BLINK



BURGESS

Discover the difference.
burgessyachts.com

BLINK



BURGESS

Discover the difference.
burgessyachts.com

BLINK



BURGESS

Discover the difference.
burgessyachts.com

BLINK



BURGESS

Discover the difference.
burgessyachts.com

BLINK



BURGESS

Discover the difference.
burgessyachts.com

BLINK



BURGESS

Discover the difference.
burgessyachts.com

BLINK

OVERVIEW.

BLINK is a 41m (134.5ft) motor yacht built by Canteri di Pisa shipyard in Italy and delivered in 2009. She was designed by Carlo Galeazzi, and she is one of only two Akhir 41 models. Built in GRP to ABS + A1 Yachting Service AMS classification, her semi-displacement hull and two 3,648hp MTU diesel engines serve up 24 knots when maxed out, and an easier 18 knots for cruising. She has a range of 1,100nm at her most economical speed of 10 knots.

Cristiano Gatto Design takes credit for BLINK's layout and design. There is accommodation for 11 guests in five cabins with en suites, including a large, full-width master cabin located aft on the lower deck with an open plan office. You will find in-and-outdoor dining and lounge spaces, with floor-to-ceiling glass doors that create a natural flow. She is also equipped with Traz zero speed stabilisation and Condaria air conditioning to ensure comfort on board.

Externally, she has teak decks throughout, and astern is a full-width, teak-laid swim platform which comes into its own at anchor. In her transom you will also find her tender garage and hydraulic lift for her two tenders: Ribline 4.8m (15.7ft) petrol jet tender and 2.2m (7.2ft) rescue tender with 9.9hp outboard.

BLINK has space for eight crew, an excellent galley and well-equipped bridge - when docking, the Hydrosystem BT80 bow thrusters are invaluable. This is a well maintained yacht ready for a new owner to embark on the next chapter.

Key features

High speed yacht with maximum speed of 24 knots

Range of 1,100nm

Accommodation for 11 guests in five cabins

Interior design by Cristiano Gatto

Lightly used with low engine hours

Tenders

4.8m Ribline petrol jet tender, 2.2m Ribline rescue tender with 9.9 HP outboard

SUN DECK

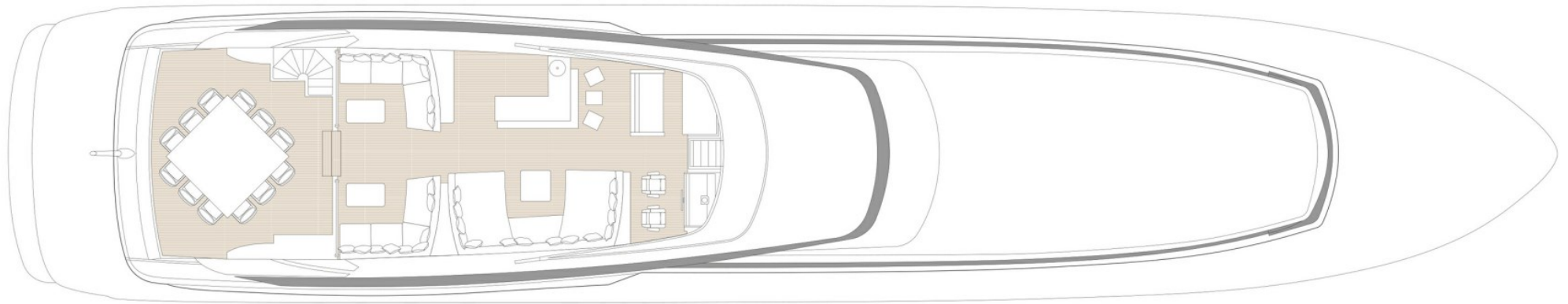

GUEST AREAS OWNER'S SUITE GUEST CABINS

MAIN DECK



■ GUEST AREAS ■ OWNER'S SUITE ■ GUEST CABINS

LOWER DECK

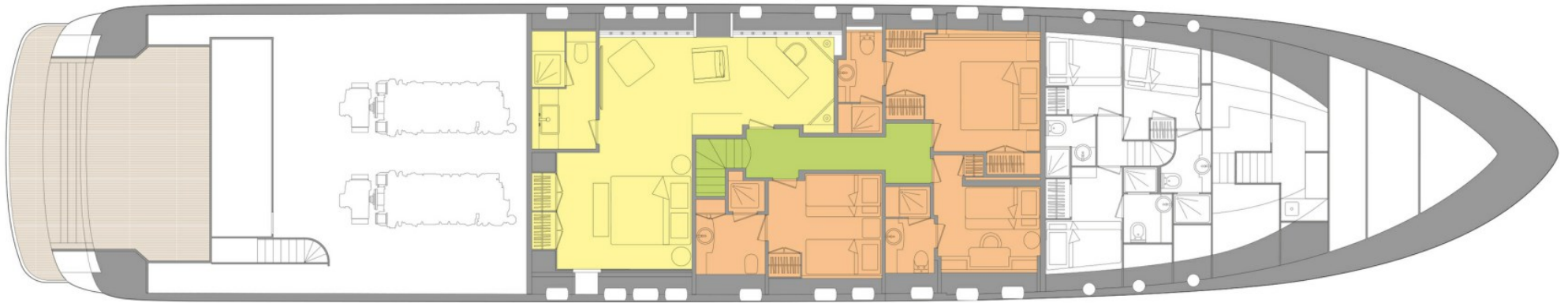

 GUEST AREAS  OWNER'S SUITE  GUEST CABINS

BURGESS

WORLD CLASS. WORLD WIDE.

London +44 20 7766 4300	Monaco +377 97 97 81 21	New York +1 212 223 0410	Miami +1 305 672 0150	Singapore +65 9665 8990	Beverly Hills +1 310 424 5112	Palma +34 971 495 413	Athens +30 210 967 1661
Dubai +971 4 425 5874	Phuket +66 7623 9739	Hong Kong +852 6496 2094	Tokyo +81 46 738 8612	Sydney +61 499 945 557	Mumbai +91 98211 67253	Rio de Janeiro +55 21 2553-3238	Shanghai +86 187 0898 6800
Guernsey +44 1481 735360							

Advertising of these vessel(s) in printed publications, on the internet or in any other medium is not permitted without prior written permission from Burgess. All particulars are given in good faith and are believed correct but they cannot be guaranteed.

Last updated: 28 abril 2026